

24" DEEP GLASS DOOR BACK BAR COOLER



EBB – Series Model : EBB69G-24

WARRANTY

5 YEAR Compressor
3 YEAR Parts & Labor



 **Operating temperature range is 32°F ~ 42°F**

Contact

201 W. Artesia Blvd, Compton, CA 90220
T. (310) 323-6586, (800) 444-6285 F. (310) 323-7524, (310) 761-1127



Please visit our website for updated Energy Efficiency information

Cabinet Construction

Heavy duty stainless steel countertop, with textured and laminated black vinyl exterior. Galvanized steel interior wall, and high quality stainless steel floor. 1 3/4" thick high density foamed-in-place polyurethane insulation. Built-in caster thread receptacles.

Refrigeration System

- Side mounted condensing unit
- Oversized condenser and evaporator coils quickly achieve and maintain desired temperature
- Forced-air cooling with oversized evaporator fan motors providing balanced airflow throughout cabinet to ensure faster temperature drop
- Removable side panel and slide-out condensing unit for convenient repair and maintenance
- Environmentally friendly CFC free R-134A refrigerant
- Air defrost controlled by electrical timer
- Copper tube and aluminum fin evaporator with anti-corrosive coating
- Energy efficient condensate drain pan assembly heated by high side copper tube
- Pre-wired and ready to plug, 115V/60Hz/1Ph, NEMA 5-15P

Doors

- Black PVC door frames
- Low emissivity double pane glass system reflects UV rays and improves insulation for maximized energy efficiency
- One piece snap-in magnetic door gaskets for easy replacement
- Heavy duty die cast door handles
- Door locks

Lighting

- Shielded vertical LED interior lighting with on/off switch for energy saving, less heat generation and enhanced illumination

Shelving

- Two epoxy coated wire shelves per section
- Stainless steel pilasters and shelf clips

Temperature Control

- Factory preset temperature, 35°F
- Temperature setting range from 32°F to 42°F
- Easy to set analog thermostat

Option

- 2 1/2" and 4" diameter casters (3 1/2" and 5" overall height)

Model	# of Doors	Capacity (Cu. Ft.)	HP	Refrigerant	# of Shelves	Capacity 20 oz. Cans / Bottles	Power (V-Hz-Ph)	Amps	Crated Weight	Exterior Dimensions		
										L	D*	H
EBB69G-24	2	20.41	1/4+	R-134A	4	700 / 441	115-60-1	4.20	336lbs (152.4kg)	68" (1727 mm)	24 1/2" (623 mm)	37 1/8" (944 mm)

Product dimensions are for general purposes and not absolute value. Product capacity is calculated based on standard industry figures. Slight variations may exist. If dimensions and capacity are critical, please contact Everest Refrigeration.

* : Depth does not include protruding door handles

24" DEEP GLASS DOOR BACK BAR COOLER



EBB – Series Model : EBB69G-24

DIMENSIONAL DATA

Net capacity cu. ft.		20.41 (577.9 cu l)
Exterior (mm)	Length Overall in.	68" (1727)
	Depth Overall in.*	24 1/2" (623)
	Height Overall in.	37 1/8" (944)
Interior (mm)	Length Overall in.	53 1/4" (1352)
	Depth Overall in.	19 1/8" (486)
	Height Overall in.	31 1/4" (795)
Crated Weight		336lbs (152.4kg)
# of Doors		2
# of Shelves		4
Capacity 20oz. (Cans / Bottles)		700 / 441
Shelf Size Length x Depth in. (mm)		27 15/16" x 18 1/2" (710 x 470)
		26" x 18 1/2" (660 x 470)
ELECTRICAL DATA		
Voltage (V-Hz-Ph)		115-60-1
Full load amperes		4.20
Feed wires with Ground		3
Cord Length ft.		9
REFRIGERATION DATA		
Refrigerant		R-134A
Compressor H.P.		1/4+ HP
BTU/HR ^a (Kcal/h)		2075 (523)

Specifications subject to change without notice.

- *: Depth does not include protruding door handles.
a: Based on evaporating temperature of 23°F(-5°C) & Condensing temperature of 131°F(55°C).

Equipped With One NEMA 5-15P Plug



Dimensions (mm)

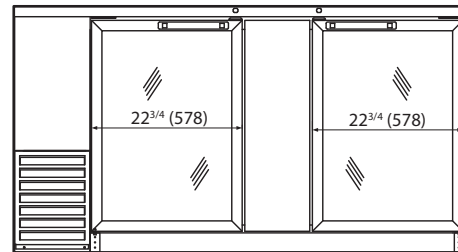

Front View

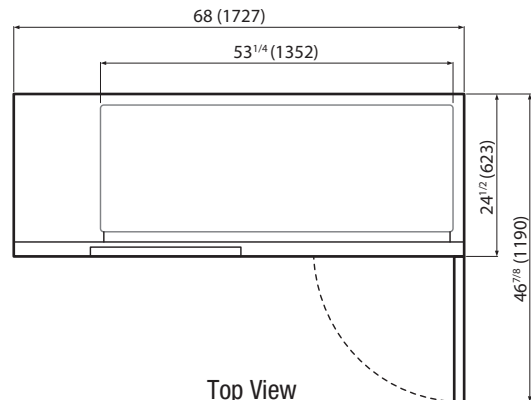

Top View

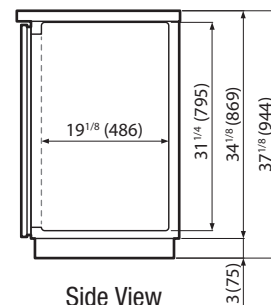

Side View



- Project / Customer _____
- Item No. _____
- Quantity _____



Warranty
5 Year — Compressor Warranty
3 Year — Parts & Labor Warranty



Contact
201 W. Artesia Blvd, Compton, CA 90220
T. (310) 323-6586, (800) 444-6285
F. (310) 323-7524, (310) 761-1127