

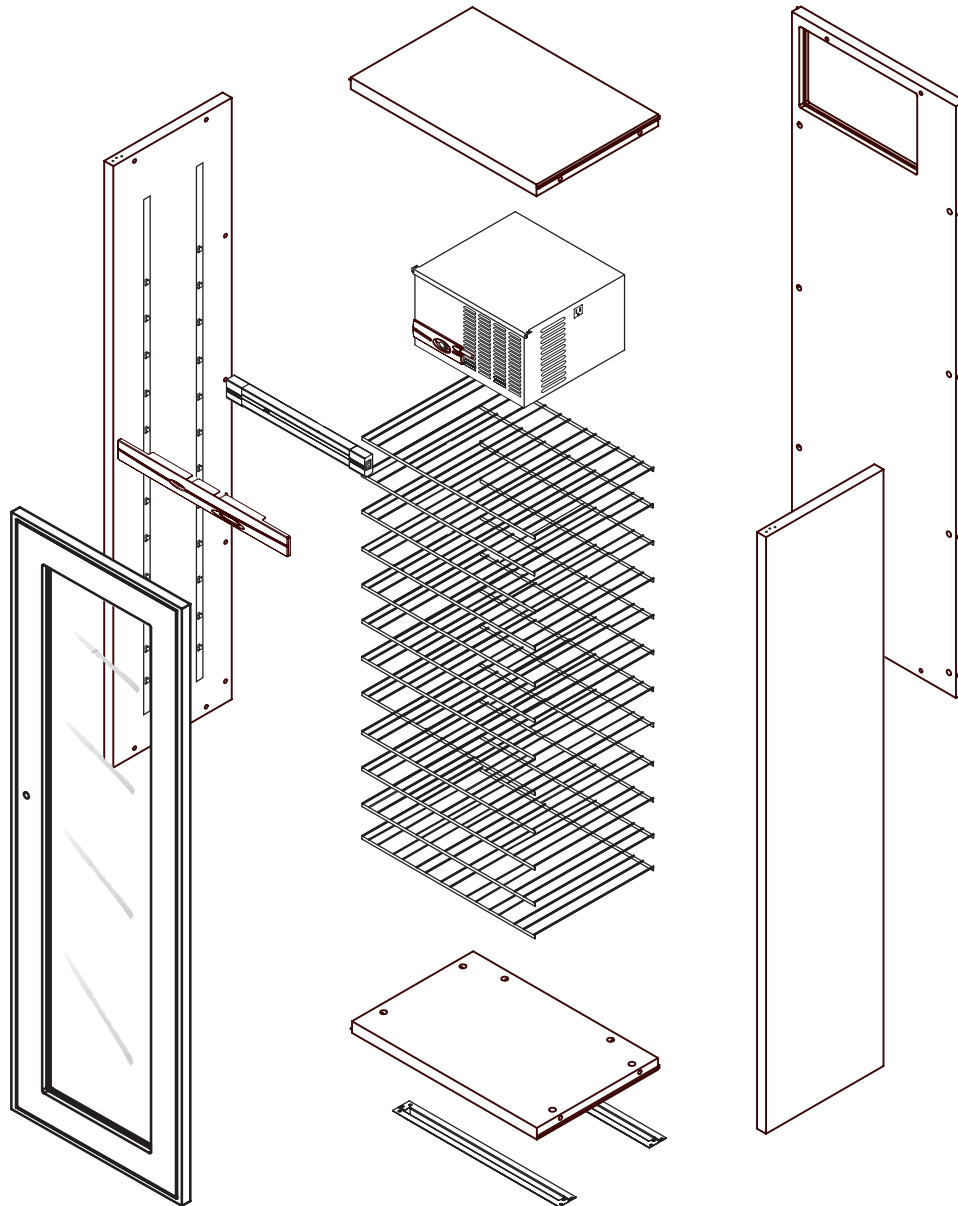

TUSCANY

110
220

Plus WINE CELLAR



READ BEFORE YOU START

1. LOCATING YOUR WINE CELLAR - Remember, it is not only an appliance but also a piece of furniture

- A. Provide 4” minimum clearance for both sides and back, keep the top completely clear. Under no circumstances should the unit be “built-in” in any way.
- B. **Never** locate your wine cellar outdoors or in an area with extremes of temperature and humidity.



Garages, attics, unfinished basements, laundry rooms, breezeways, closets or any unventilated room. In other words these units must be installed in air-conditioned environments which do not “trap” the warm air being exhausted.

- C. Temperatures in surrounding area must not exceed 80 °F (25 °C) with humidity levels not to exceed 70% R.H. (Relative Humidity). Never set your temperatures below default (57°F) whenever ambient conditions are warm (above 75°F) or humid (above 50%R.H.).
- D. Outlet power must be a DEDICATED separately fused, grounded, 15 Amp 110 - 120 V line.
- E. You must monitor your unit DAILY. If unit is in “Alarm”, unplug the unit immediately. Always check for any water (condensate) leaks.

Vintage Keeper will not be liable or responsible for incidental or consequential damages. (See Warranty).

- F. Place unit in a clean area and allow access to the exterior surfaces for periodic vacuuming of the condensor coil. (See troubleshooting for details.)
- G. Always remove all bottles before relocating your wine cellar.
- H. Keep Instruction Manual for reference (Download manuals at www.koolspace.com if lost).

2. AREA FOR ASSEMBLING YOUR WINE CELLAR

Choose a clear 12’ by 12’ area with a level floor and carpentering to help reduce scratching of surfaces.

3. TOOLS

- * Hex wrench (included)
- * #2 Phillips screwdriver
- * #3 Phillips screwdriver or 1/4” Flat Screwdriver
- * Carpenter’s level
- * Helper or two is strongly recommended

4. TEST THE COOLING UNIT

Plug it in for a few minutes on a table top, to verify that controls and display are functional, and that the unit is producing cool air after a few minutes of operation.

Note that the electronic controller has a one-minute cautionary delay between initial plug-in and start-up of the compressor.

HARDWARE KIT

A

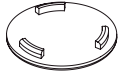

Cam Cap
x 20 (x24)*

B

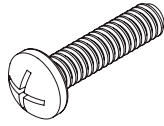

Phillips Bolt
x 2

C

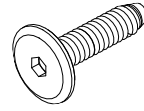

Hex bolt
x 14

D

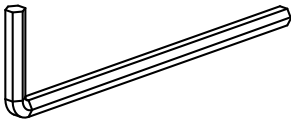

Hex wrench
x 1

E

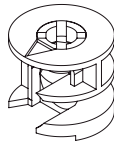

Cam
x 20 (x24)*

F

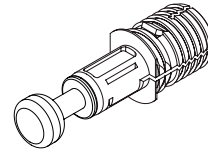

Cam Pin
x 20 (x24)*

G

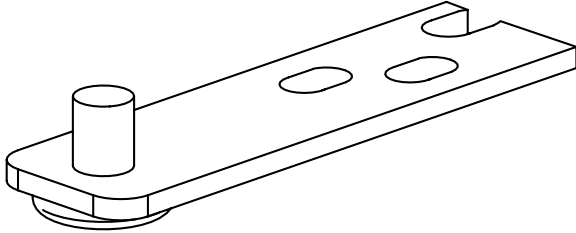

Hinge
x 2

H

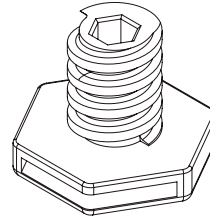

Leg
x 4

I

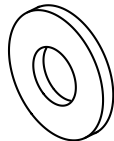

Washer
x 1

J

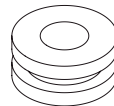

Rubber Grommet
x 2

K

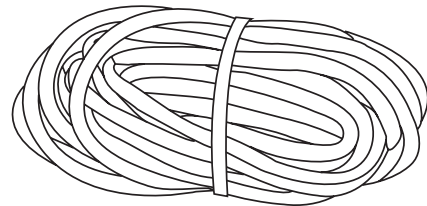

Panel Insulation Strip
x 1

***NOTE :** Hardware quantities for Model 220 are indicated in parenthesis.

STEP 1 : PANEL PREPARATION

CAUTION :

1. Watch for sharp staples on boxes.
2. DO NOT STEP ON PANELS
3. The manual will give a recommended order to open boxes, it saves space and time.

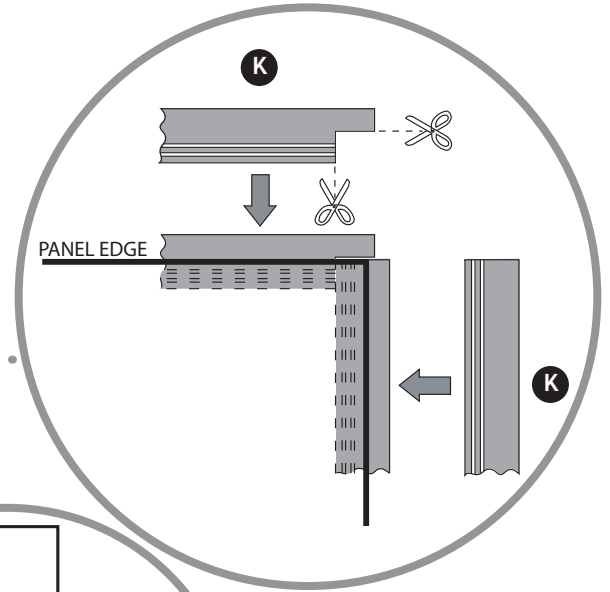
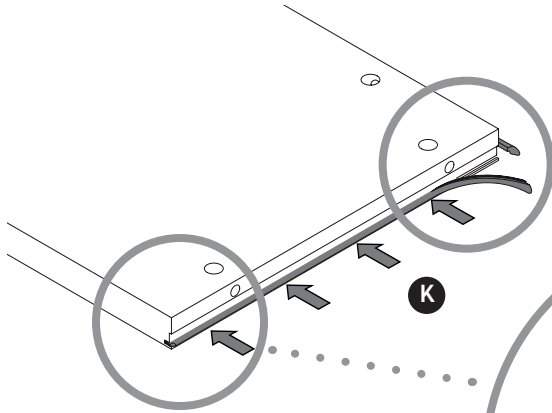

Open Box V1.

- 1 Install INSULATION STRIP to Back, Top, and Bottom Panels. PUSH IN FULLY!
- 2 Insert Cam Pins (F) in BACK PANEL'S pre drilled holes.

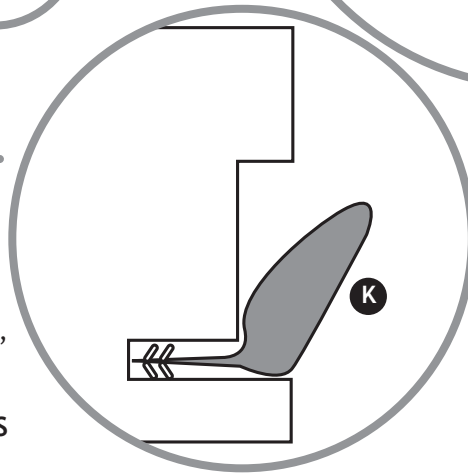

CAUTION : DO NOT BREAK CAM PIN TABS!

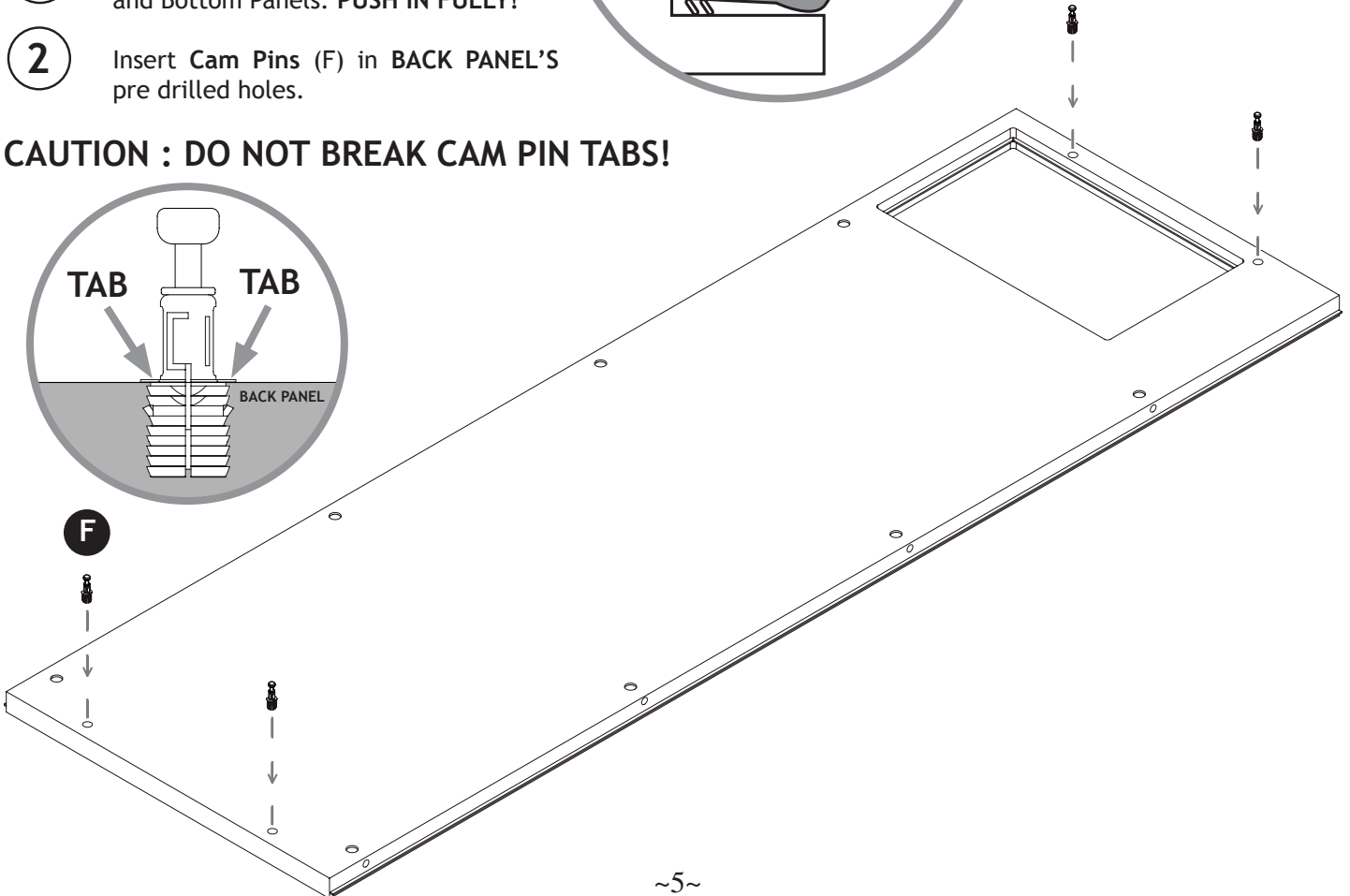
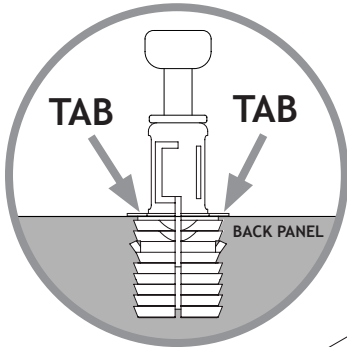

STEP 2 : CABINET ASSEMBLY

1 Attach Top and Bottom to Back by **CAREFULLY** aligning edge holes over Cam Pins and gently push together to avoid damaging cam pins. **DO NOT BANG OR SLAP PANELS TOGETHER!!!**

2 Insert Cam and make sure **Arrow** points to outside edge.

Gently push down to bring panels together before you tighten the Cam.

Cam Arrow faces away from outside edge when tightened.

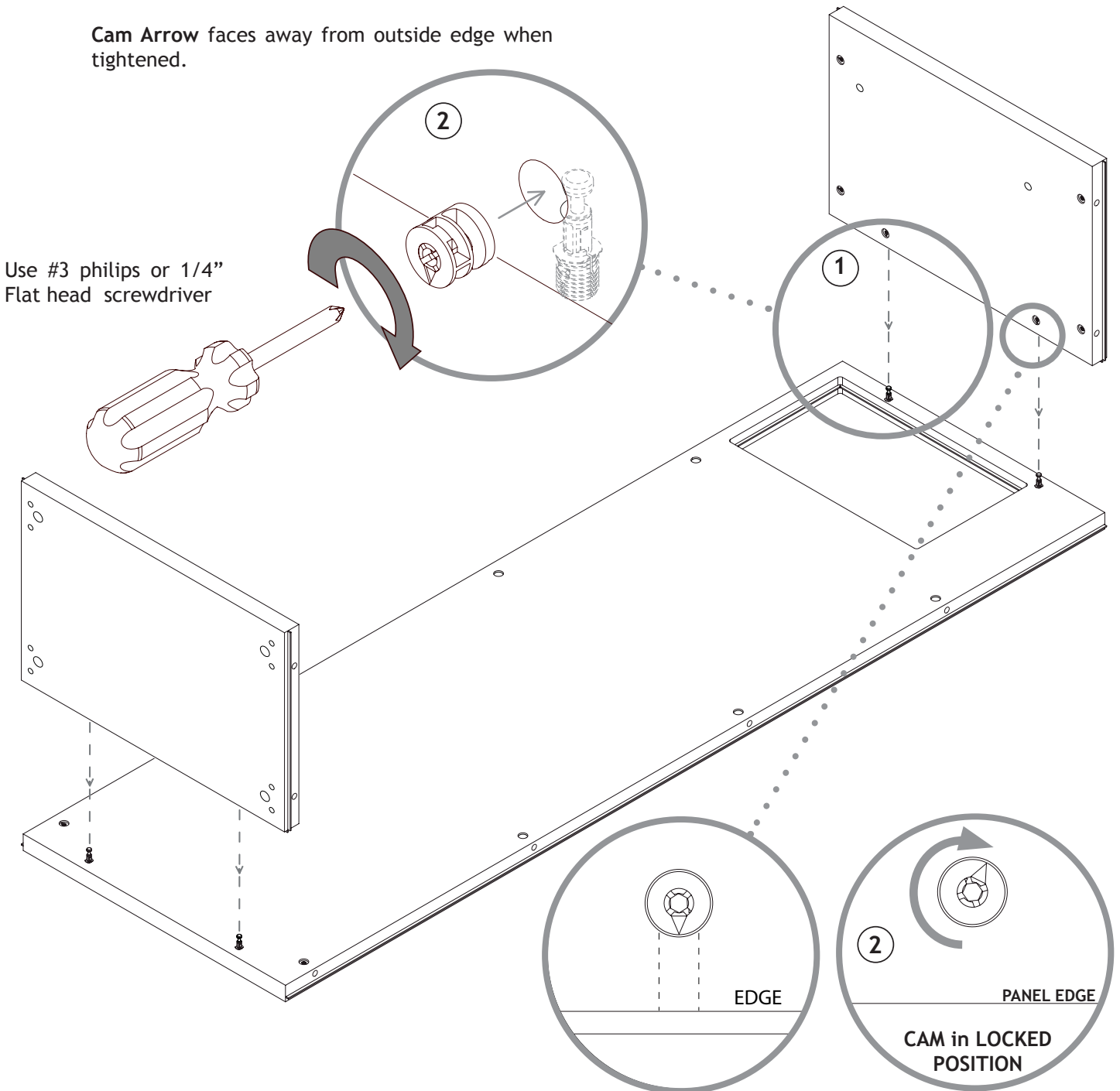

STEP 2 : CABINET ASSEMBLY CONTINUED

Open Box V5 or V2.

- 1 Insert Cam Pins (F) into SIDE PANEL'S pre drilled holes both sides.
- 2 Attach SIDES to Back/Bottom/Top by Carefully aligning edge holes over Cam Pins and gently push together to avoid damaging cam pins. **DO NOT BANG OR SLAP PANELS TOGETHER!!!**

Insert Cam, Push Panels together before tightening Cam.

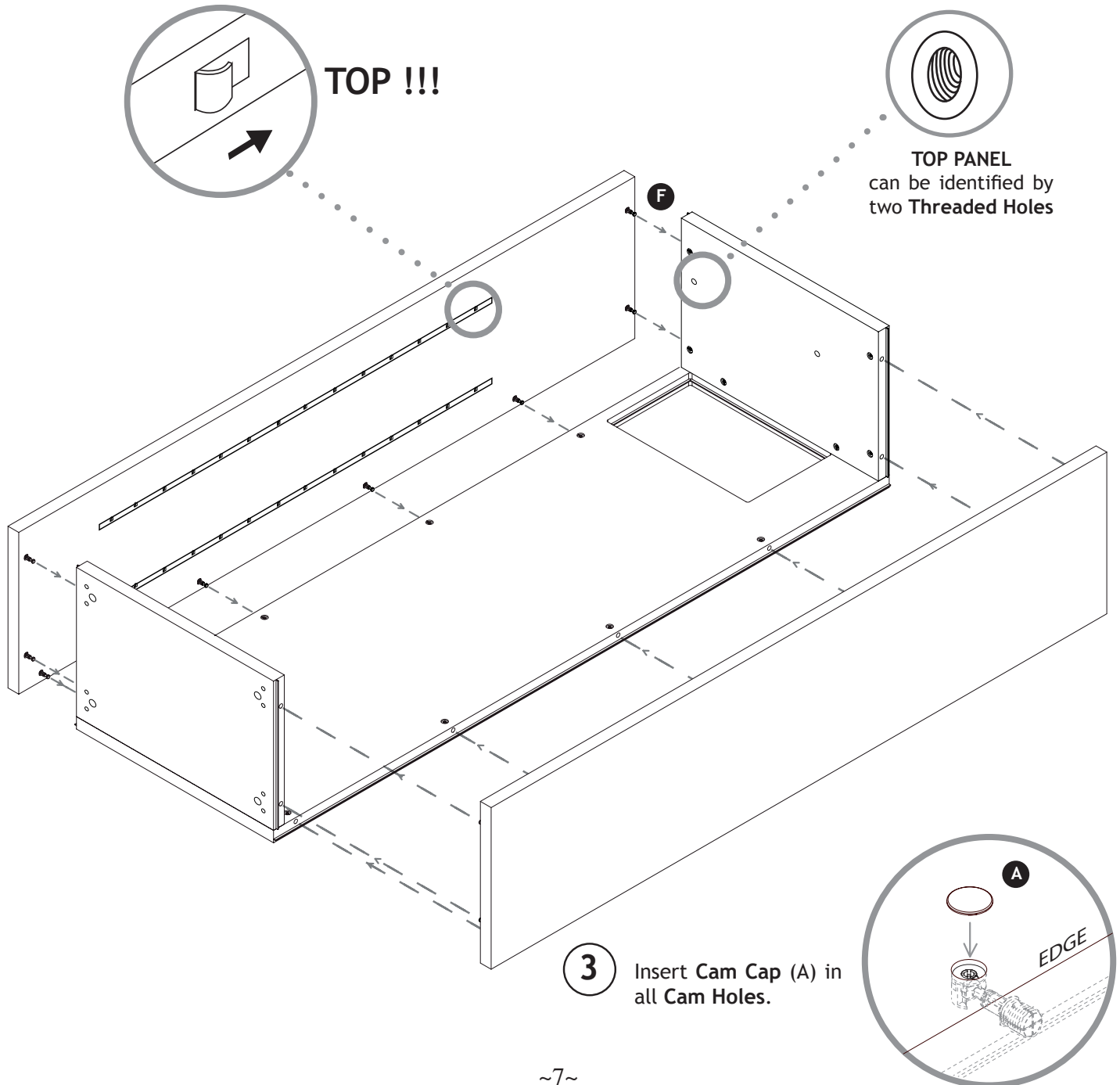

STEP 3 : HINGE, BASE AND LEGS INSTALLATION

- 1 Fasten one **HINGE (G)** to the **SIDE** of the cabinet

NOTE : Hinge can be on either side of the cabinet.

- 2 Install four **LEGS (H)** into **BASES** fully in.

- 3 Fasten **FRONT BASE** to the **BOTTOM** of the cabinet (**FRONT BASE** has to be set with end tabs away from front edge)

- 4 Fasten **BASE** with **HEX BOLTS (C)**

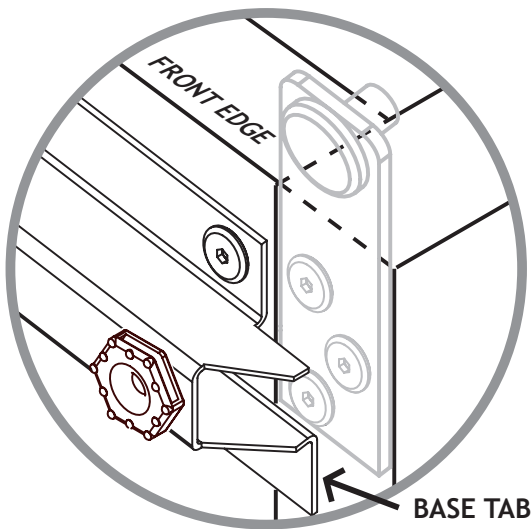

NOTE: Fasten base with base tab away from the front edge, then fasten and adjust the hinge before fully tightening **HEX BOLTS (C)**

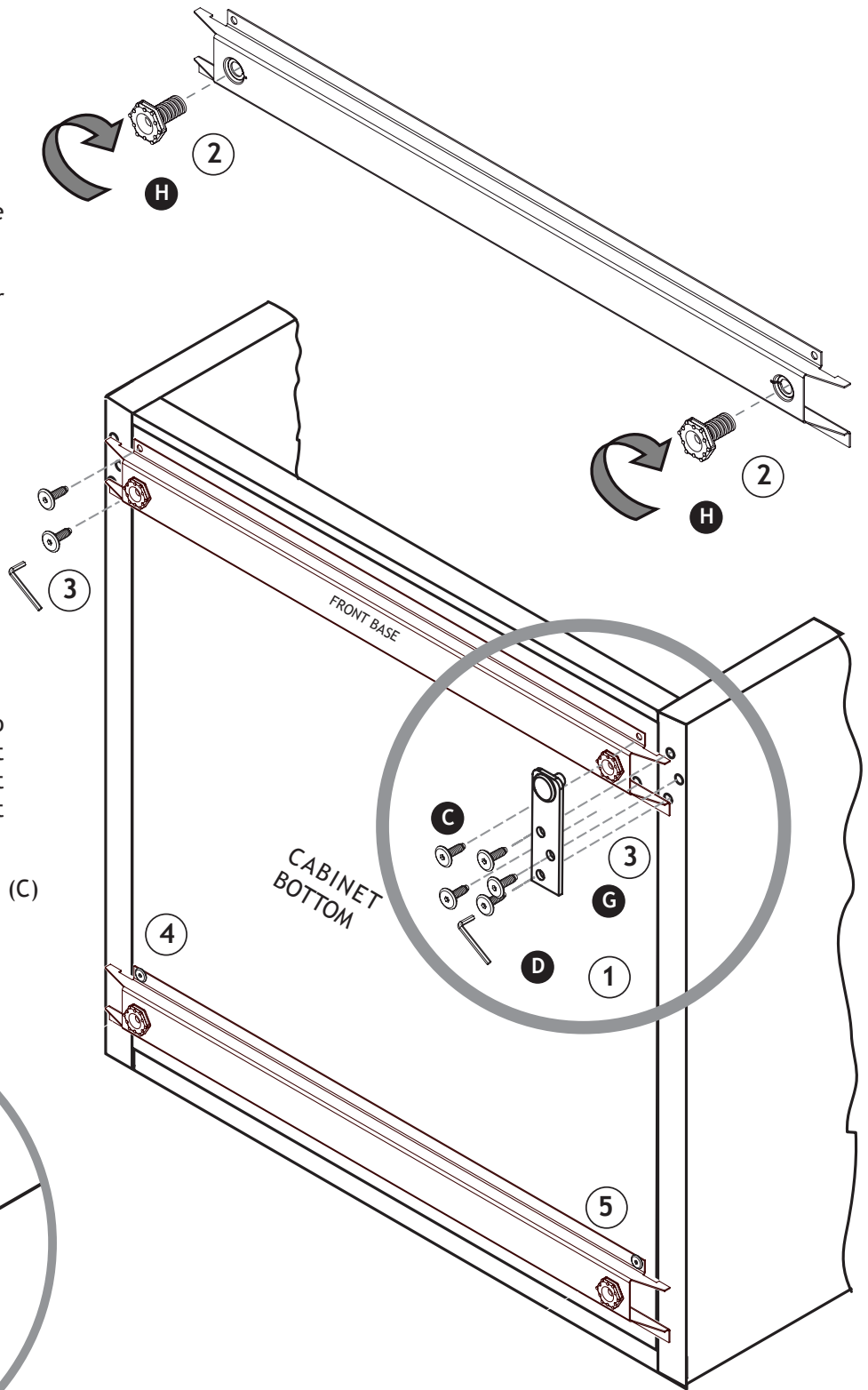

- 5 Raise cabinet and adjust the level by turning (counter clockwise) the **LEGS (H)** as needed.

STEP 4 : SHELVES

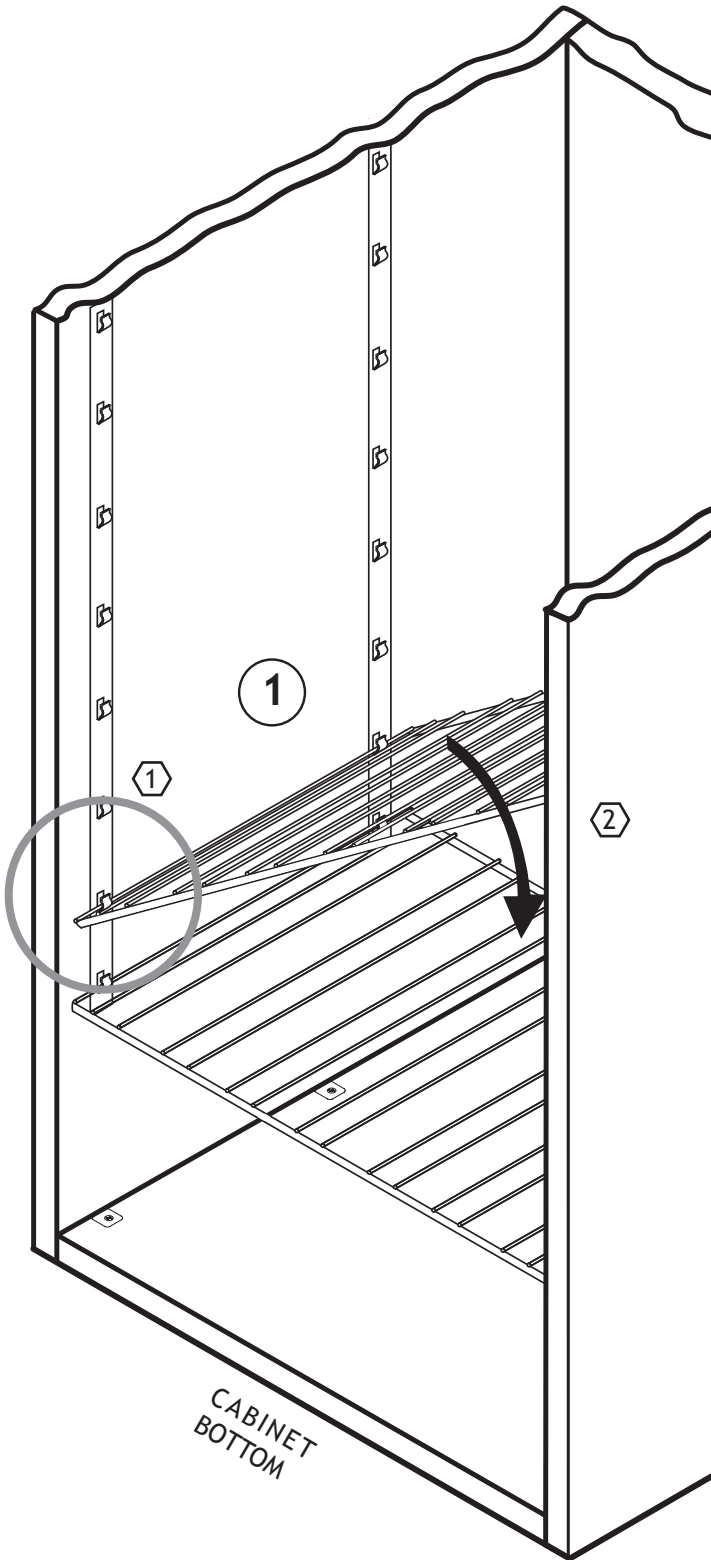

1 Open box V4

Hook **SHELVES** into hangers starting from the bottom of cabinet

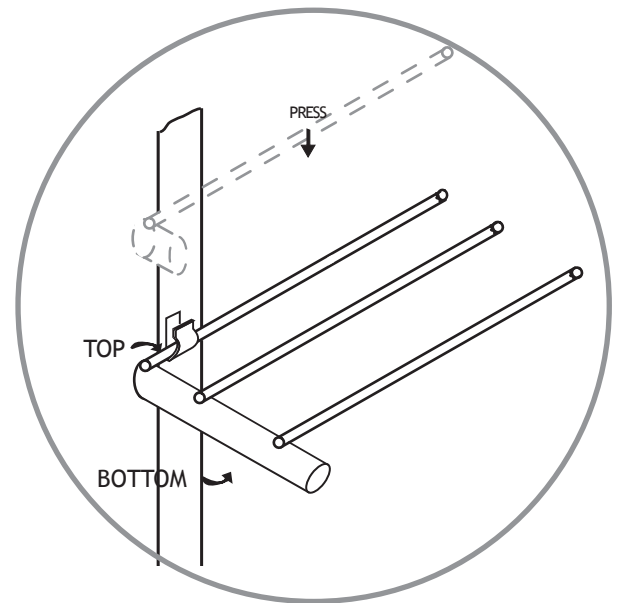

HINT :

1 Snap **SHELVES** into hangers on one side

2 Push the **SHELVES** down to snap into opposite side hangers

STEP 5 : COOLING UNIT INSTALLATION

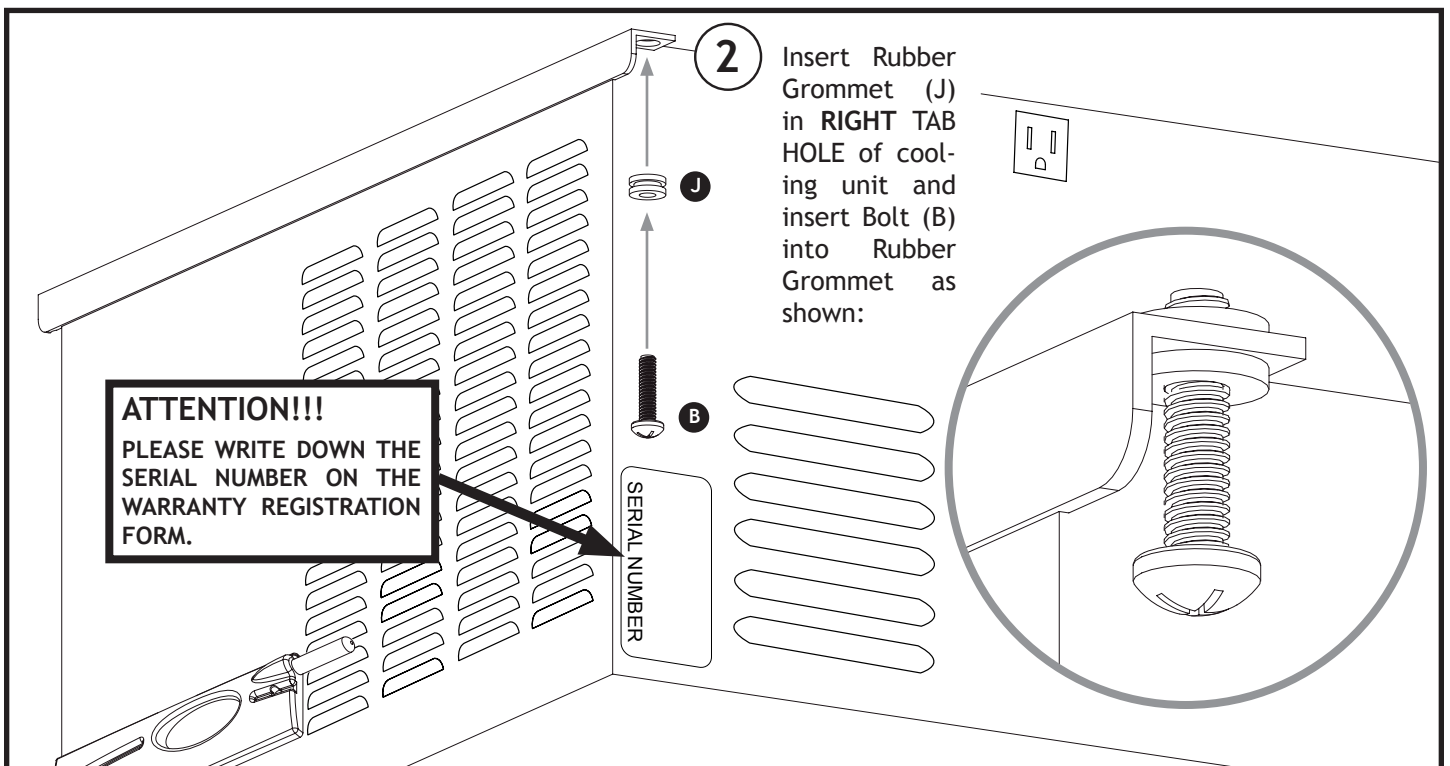
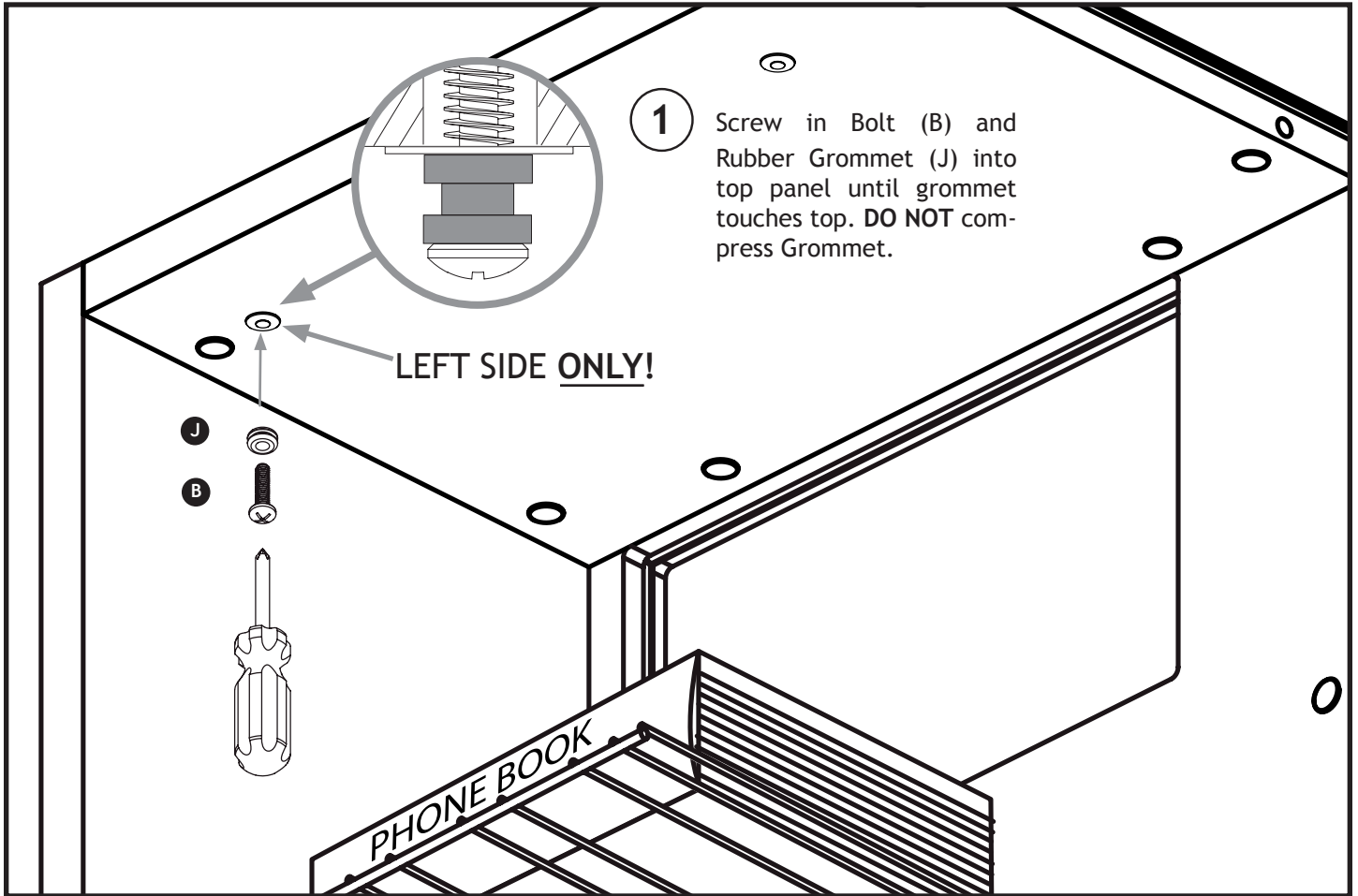

STEP 5 : COOLING UNIT INSTALLATION CONTINUED

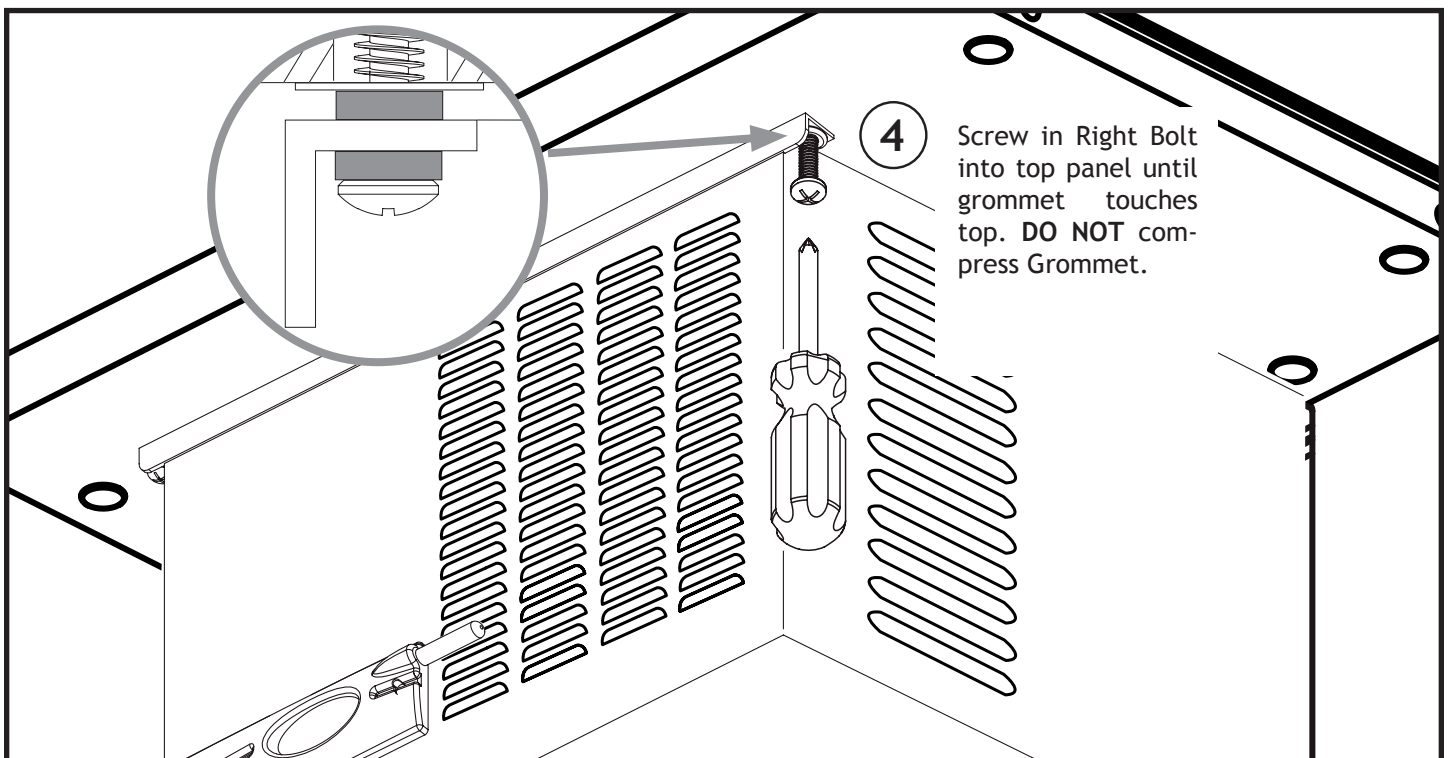
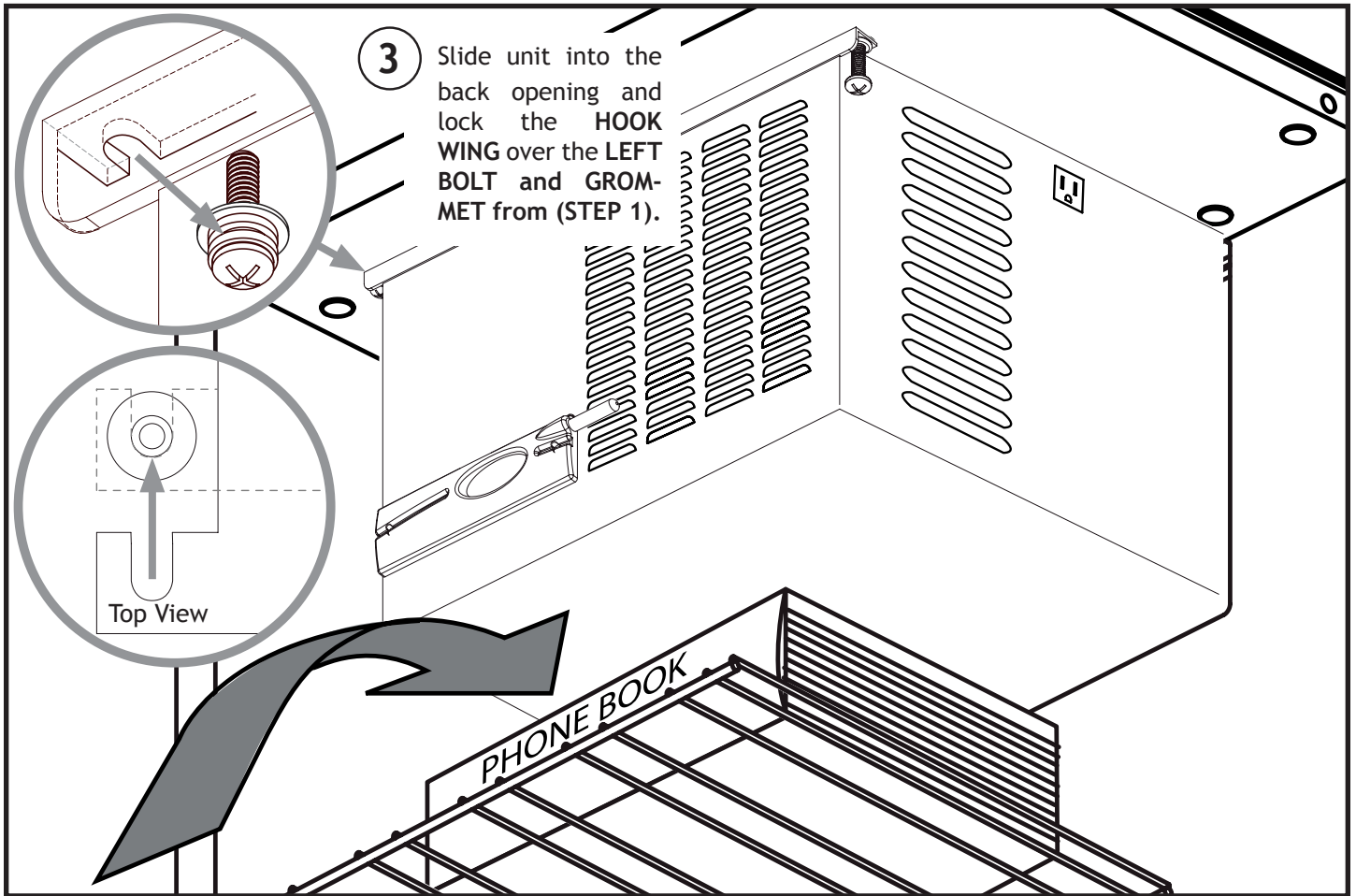

STEP 5 : COOLING UNIT INSTALLATION CONTINUED

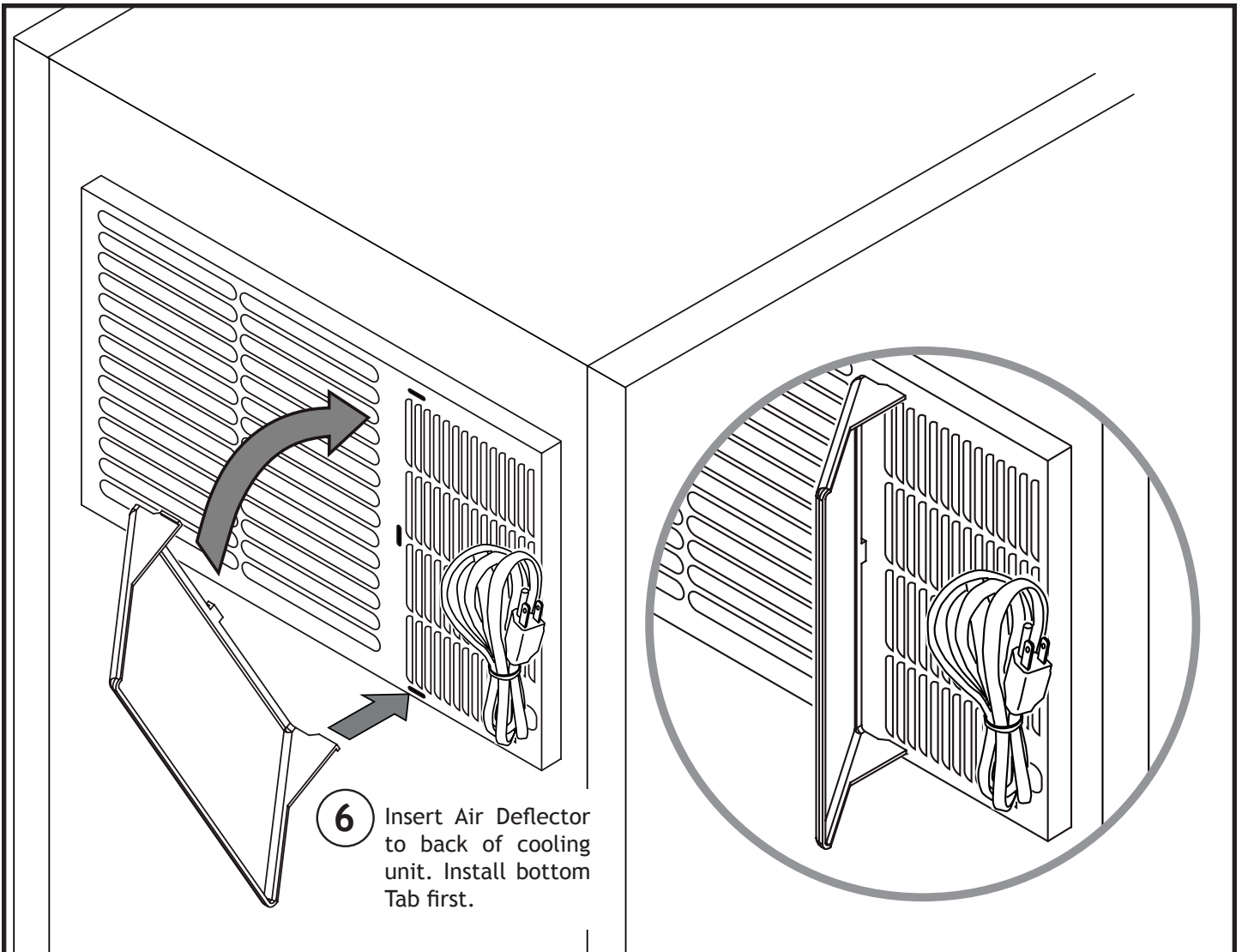
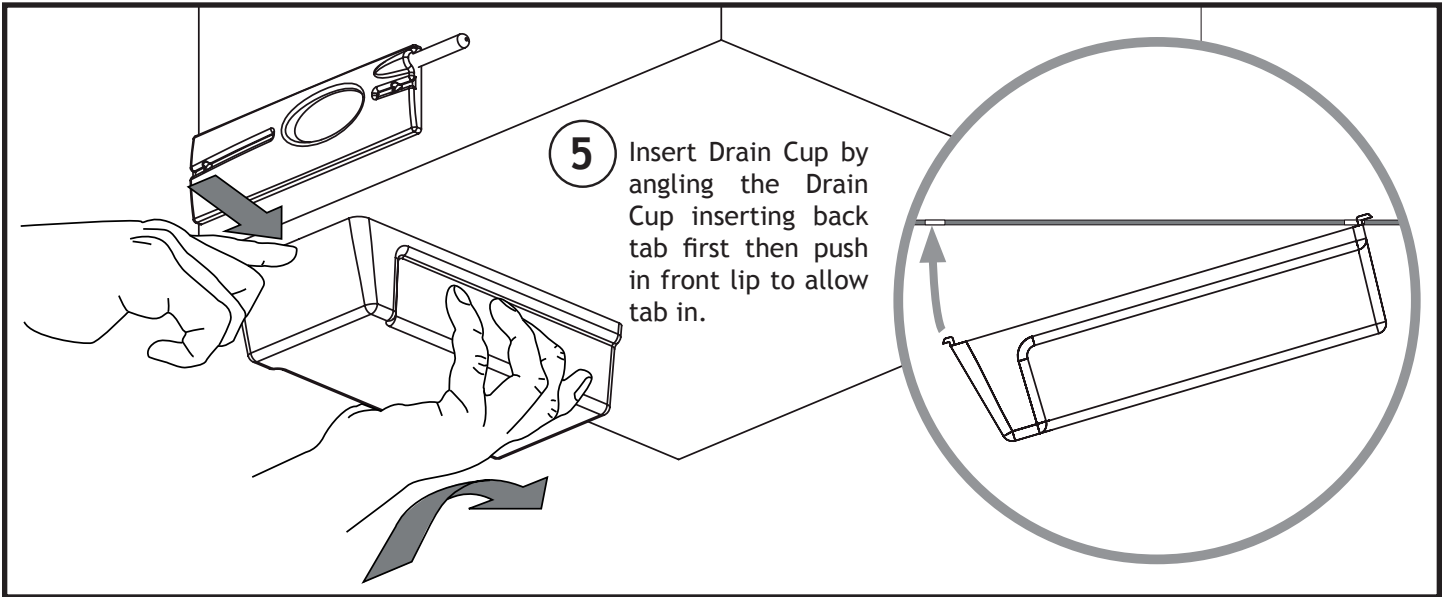

STEP 5 : COOLING UNIT INSTALLATION CONTINUED

NOTE: If unit is operated according to specifications overflows will not occur. Excess condensation is only caused by extreme conditions. Unit will shut off at 72 °F and will restart when temperature drops or unit is replugged. (In this case insert hose to drain hole, cut to appropriate length.)

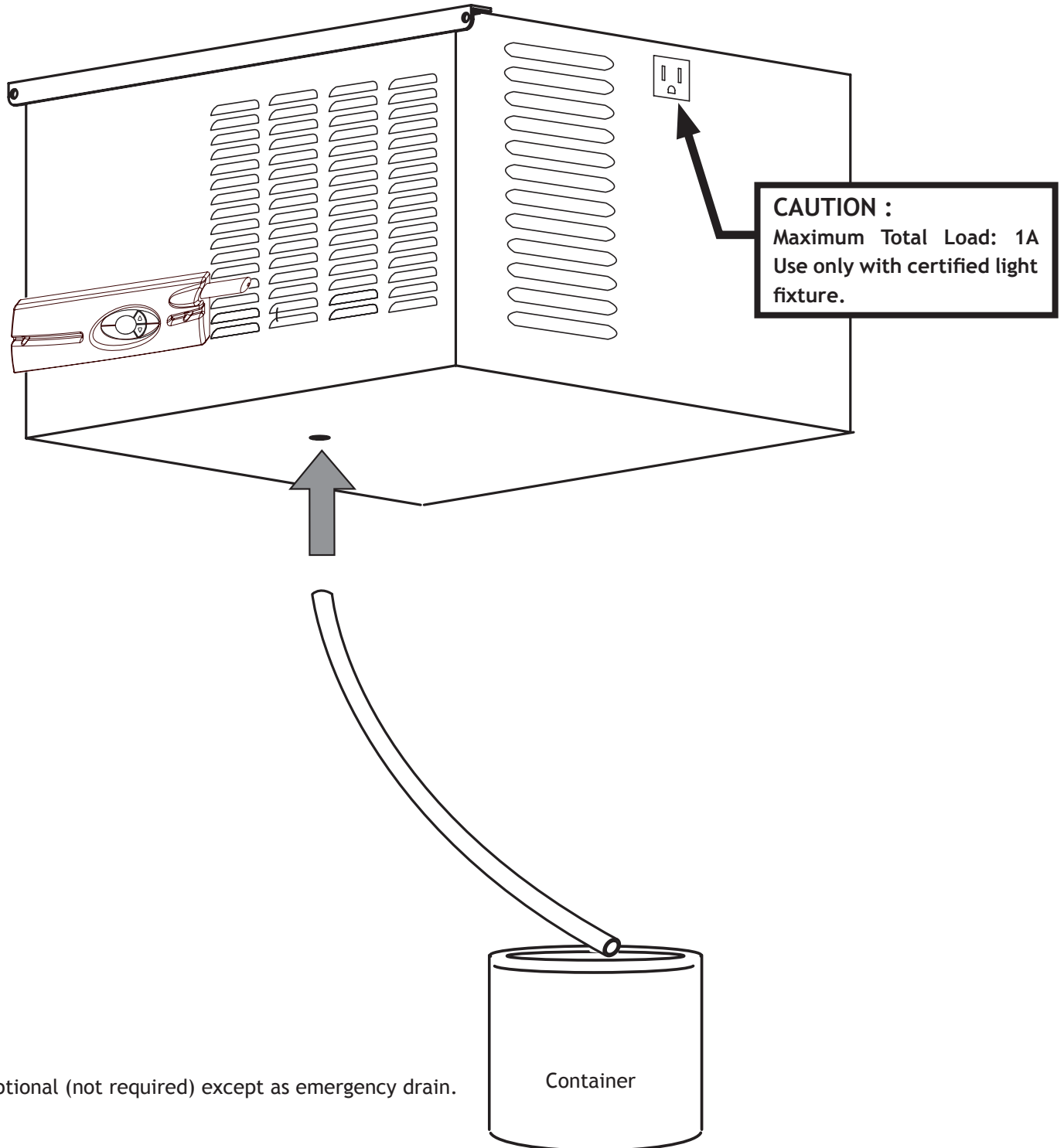

STEP 6 : LIGHT AND LIGHT COVER INSTALLATION

1

Fasten **LIGHT CLIPS** into mounting holes predrilled on front edge of **TOP** panel

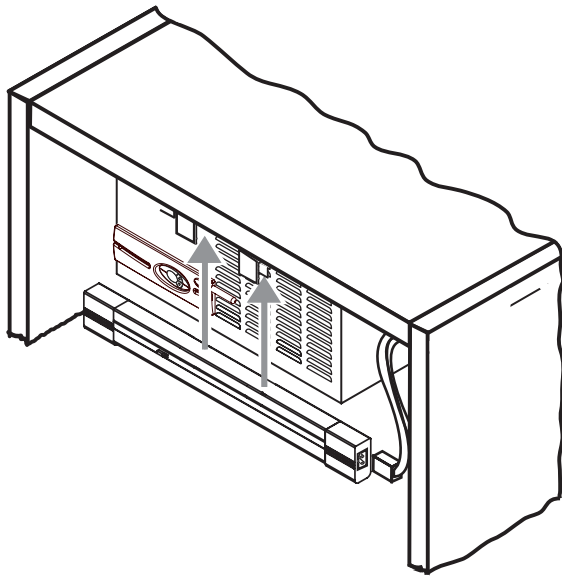
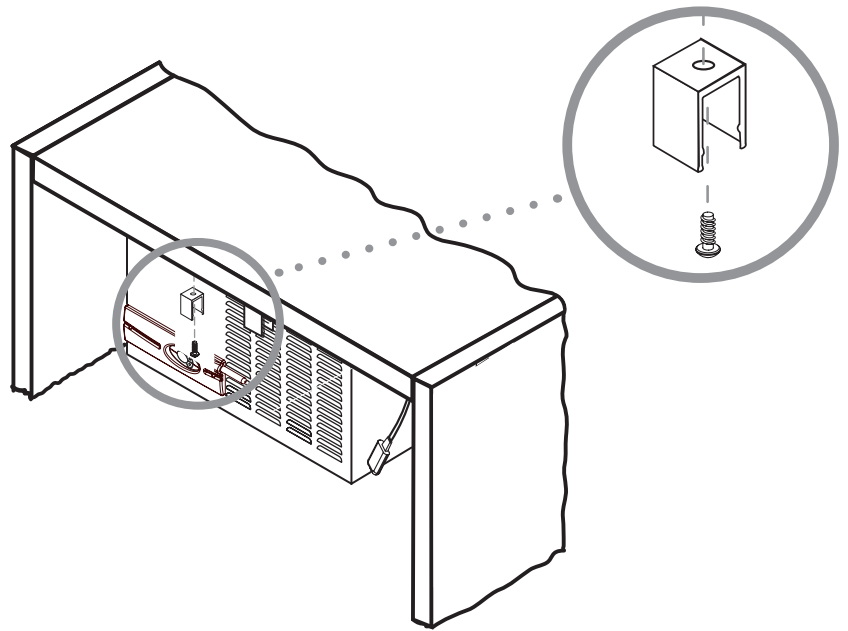

4

Snap **LIGHT** in **LIGHT CLIPS**
Plug small end of power cord into socket on side of light

5

Snap **LIGHTCOVER** over the **LIGHT**

HINT: To hide excess light cord, tuck into top space of cooling unit.

NOTE : To replace the light bulb:
1. Press down on ends of light behind to release cover.
2. Remove cover as light ends are pushed down

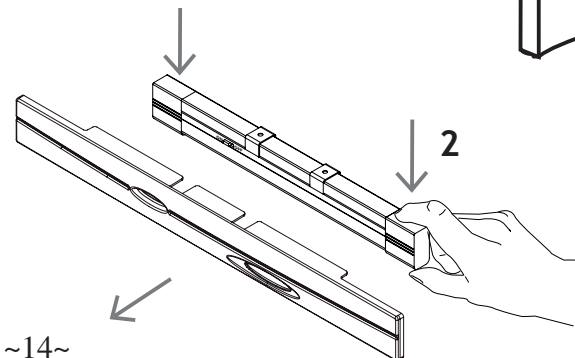
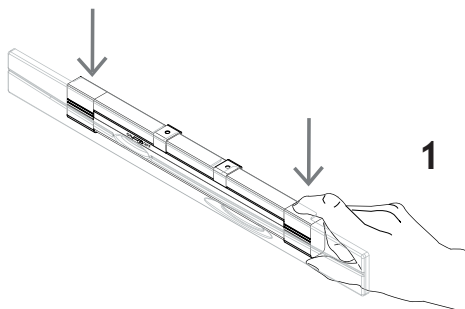
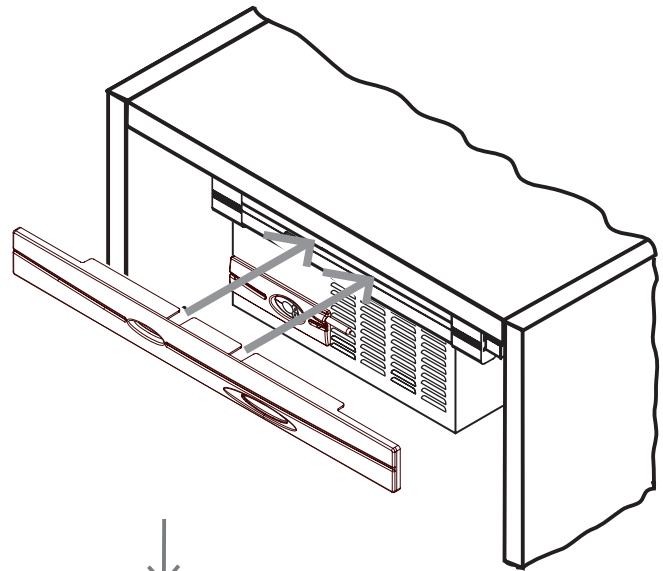

STEP 7 : DOOR INSTALLATION

- 1 Open box V3
Place **WASHER (I)** on **BOTTOM HINGE (G)**
- 2 Insert **DOOR** onto **BOTTOM HINGE (G)**

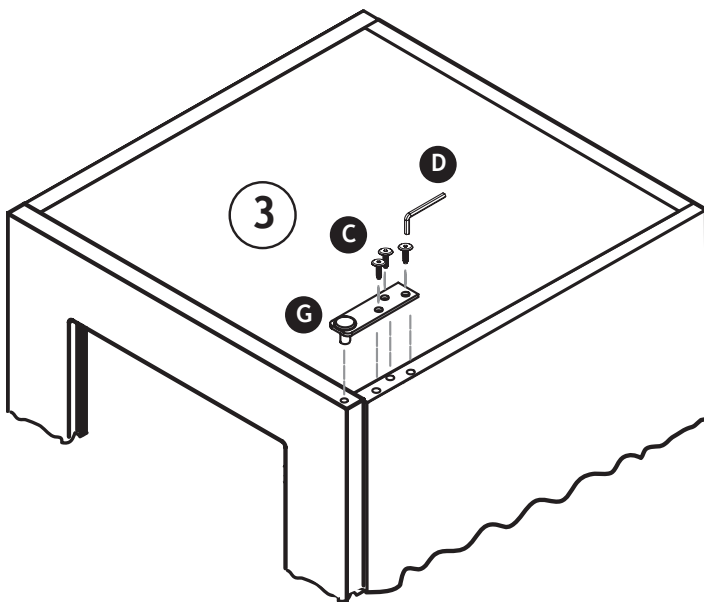
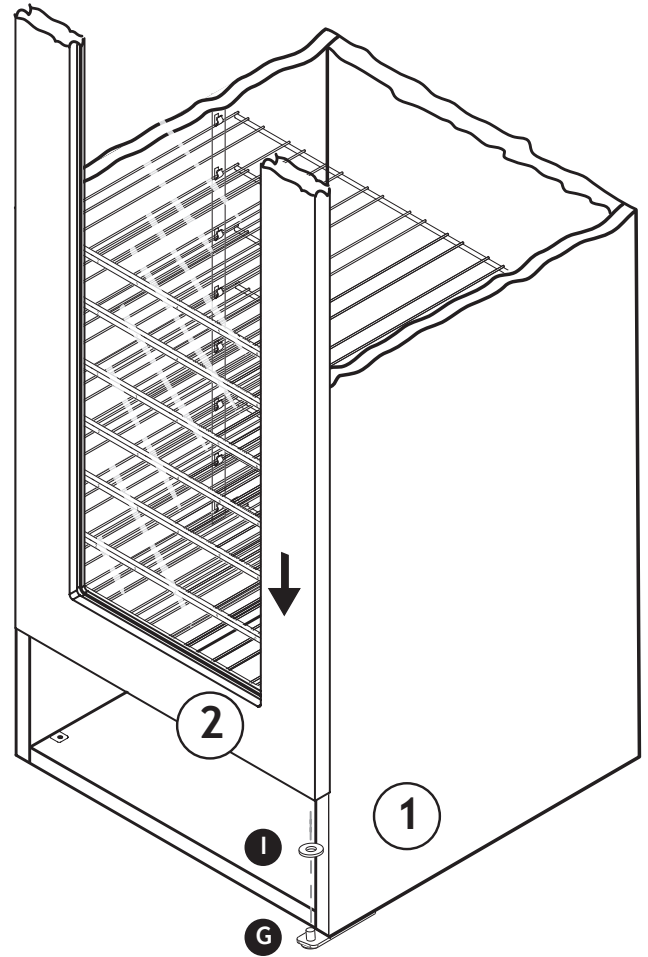

- 3 Install **TOP HINGE (G)** with **HEX BOLTS (C)**

NOTE : Adjust final position of the door before tightening the bolts

CONTROLS : PLUG IT IN (wait one minute) and ENJOY!

- FEATURES:**
- Default SET temperature 57° F/14° C (ideal for wine storage).
 - Calibration option of the temperature sensor.
 - SET temperature range 52°F-72°F.
 - Digital temperature sensor.
 - Dual display F°/C°.
 - Magnetic overflow sensor.
 - Settings are stored in memory for power failures.
 - Pre programed software will reach the quietest most efficient operation.

DISPLAY:

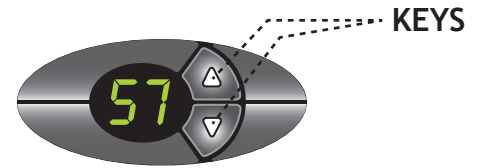

- OPERATION:**
- The display will show the detected temperature until the temperature will fall within 3° of the SET POINT.
 - If the temperature is above the default 57° F + 1° or other preset value, after a **delay of 1 minute** the fan will start, followed by the compressor within the next minute.
 - The unit will cycle ON/OFF based on the temperature reading. Fan speeds are automatically set by the controller to achieve optimum performance.
 - Minimum ON and OFF cycle times are imposed by software, to prevent "short cycling".

CONTROLLER OPERATION	ACTION	DISPLAY EXAMPLE	
		BEFORE	AFTER
TO MODIFY THE SET TEMPERATURE (range is 52-72°F):	PRESS and RELEASE ▽	57°	57°
	To increase: PRESS ▲ once per degree	57°	58°
	To decrease: PRESS ▽ once per degree	57°	56°
	The new value will be memorized and the controller will reset automatically.		
TO CHANGE FROM °F to °C or °C to °F:	PRESS and HOLD ▽ until buzzer sounds in 5 seconds	57°	14°
	The new value will be memorized and the controller will reset automatically.		
TO CALIBRATE:	HOLD DOWN ▽ KEY, PRESS ▲ and RELEASE BOTH.	57°	57°
	Wait 5 seconds	57°	F0
	USE ▲ or	F0	F1
	▽ for each degree of offset	F0	-1
NOTE: A negative offset ▽ will result in a warmer cabinet and a positive offset ▲ will result in a cooler cabinet. The new value will be memorized and the controller will reset automatically.			

SAFETY FEATURES:

- ALARM:**
- If the temperature exceeds 72° F the unit will shut down, a sound warning will start and the display will blink **AL** alternating with the temperature reading.
 - This function is disabled in the first 4 hours "Cool Down" period or after any reset for another 4 hours.
 - The unit will restart and continue the cooling and cycling if the temperature falls below 72° F.

TO RESET: - Unplug and re plug the unit.

OVERFLOW: - If the condensate pan is filled due to excessive humidity the unit stops, and warns with an acoustic signal and the "CUP FULL" message on the display.

TO RESET: Empty cup located under the cooling unit.

MAXIMUM CAPACITIES AND LOADING TIPS

Maximum capacities and sample loading arrangements for Vintage Keeper Tuscany wine cellars are illustrated below. Note the variations in shelf height, to accommodate the widest variety of bottle types and sizes. Standard Burgundy and Bordeaux bottles are best arranged with necks facing out; some taller bottles may need to be arranged neck to neck. Never stack bottles more than two rows high on a shelf; all shelves must be installed as directed. Avoid placing bottles directly in front of the cooling unit's circulating fan for more uniform temperature in cabinet.

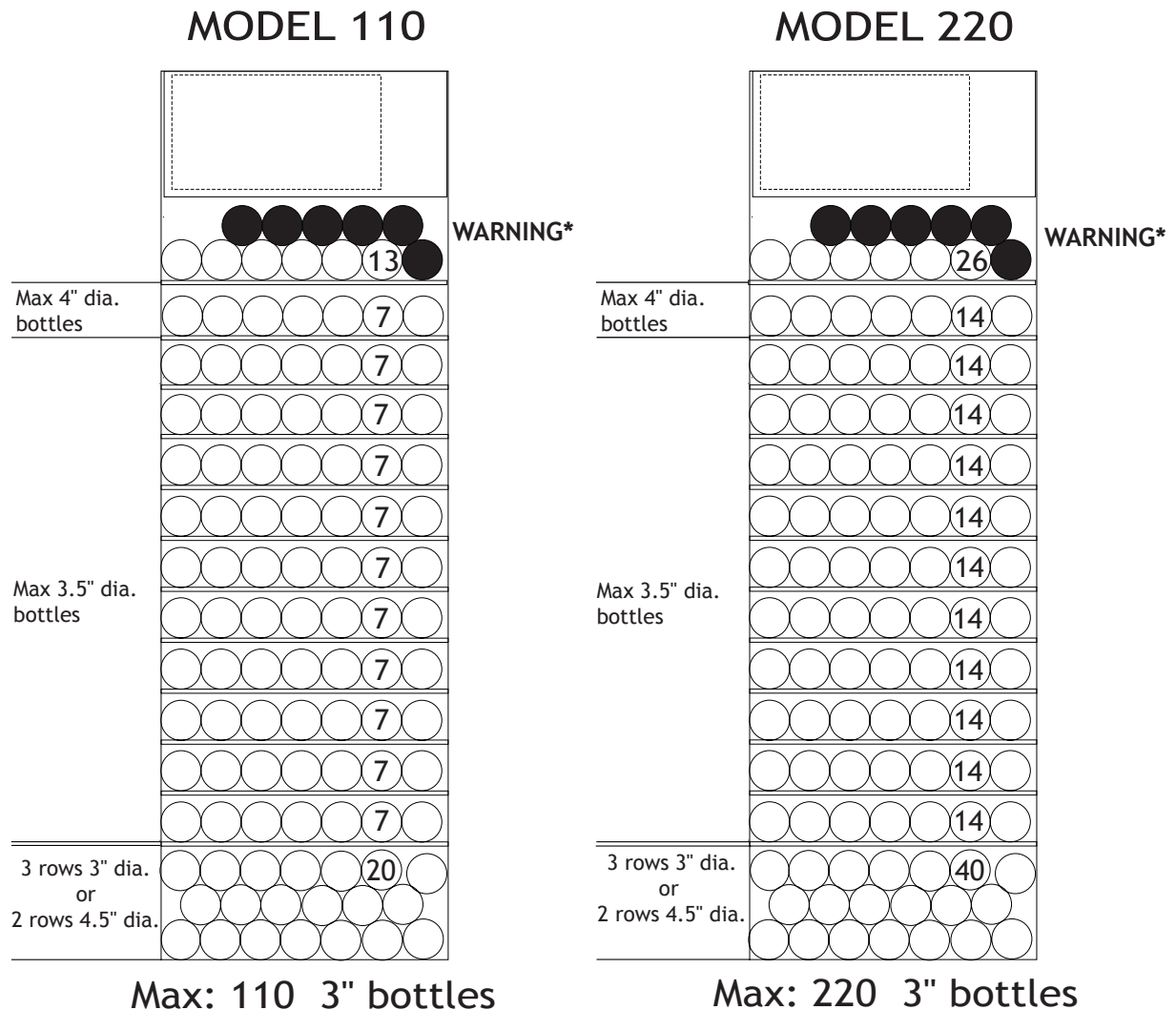

***WARNING:**

Bottles in black will be in the cold air stream and could block airflow efficiency in some circumstances (warm or humid areas). This area of the cabinet should have the coldest temperature and may be used as your "chilling" section.

TROUBLE SHOOTING GUIDE

Although each Vintage Keeper cooling unit has been carefully tested at every stage of manufacture, occasional problems arise, the majority of which are due to rough or careless handling during shipping or installation. Other problems may derive from improper cabinet assembly, power interruption or surge, low line voltage (less than 105V), or failure to clean the unit regularly (see illustration below). The following may help you determine what the problem may be; what steps you can take to correct it, and what further steps may be required. Additional Trouble-Shooting information and downloadable documents are available in the "Support" area of our web site: www.koolspace.com

Cleaning the coil

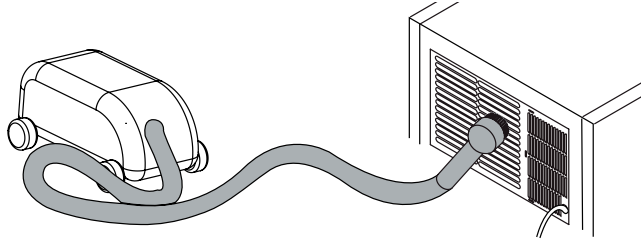

Coil is located at the top of back panel.

Vacuum it periodically

IMPORTANT NOTE:

In order to provide maximum protection for your valuable wine collection, the following steps are highly advisable. First and foremost, have your wine collection adequately insured. Second, install a battery-powered heat-sensitive alarm to warn of any loss of cooling due to power interruption. Third, monitor your storage and ambient conditions on a regular, daily basis. Fourth, install a high quality surge suppressor to protect against sudden power fluctuations. Fifth, clean the unit as directed, on a regular basis, every 3 to 4 months vacuum the cooling unit coils (check our website for more info). Sixth make sure to check water level in the **DRAIN CUP** periodically and empty. Be advised, also, that Drobot-Vintage Keeper cannot in any event be liable or responsible for incidental or consequential damages.

IF:	CHECK:	THEN:
<p>COOLING UNIT DOES NOT RUN AT ALL WHEN PLUGGED IN</p>	<ul style="list-style-type: none"> - Is the unit plugged in? - Is the power supply operational? - Is the LED display functional and are fans running? - Is there any evidence of shipping damage on the cooling unit or packaging materials? 	<ul style="list-style-type: none"> - Note that the unit has a 1-minute cautionary delay between plugging in and full start-up; this is a built-in safeguard to protect the compressor in the event of sudden power failure - Note that the power supply must be a dedicated, separately-fused and grounded 15 Amp, 120V line. If an extension cord must be used, it must be rated for 15 Amps. Do not share the outlet with other appliances. Unplug Unit, remove controller, check replaceable fuse (0.5A SLOW BLOW, 250V, 5X20mm) in the controller. - If the unit is receiving power yet fans or compressor fail to run, unplug for ten minutes, then try again
<p>COOLING UNIT RUNS BUT DOES NOT COOL SUFFICIENTLY</p>	<ul style="list-style-type: none"> - Is the storage temp properly set? - Is the cabinet properly assembled, with all joints air tight? - Is the door properly adjusted to seal tightly when closed? - Is airflow to and from the cooling unit unobstructed? - Is the ambient air temperature within the specified range? - Are any exterior surfaces of the cabinet exposed to sunlight? 	<ul style="list-style-type: none"> - Note that the unit may take a few days to achieve the desired storage temperature, even in a properly located, airtight cabinet - Take steps to reduce ambient temperatures and compensate for additional heat gain if any cabinet walls receive direct sunlight - If gaps are visible at any panel joints, ensure that you have tightened all cams in all panels, to ensure an airtight seal as detailed in our instructions - Take steps to improve circulation of air to and from the unit - Adjust the door, if necessary, to seal tightly by re-positioning the upper hinge and improving the cabinet level - Install the air deflector as directed - Increase your SET TEMPERATURE - Clean the fan and grille areas - If the problem persists, go to our website at www.vintagekeeper.com and perform the "cooling unit diagnostic" in the support section.

LIMITED WARRANTY AND PRODUCT SUPPORT

ONE YEAR LIMITED WARRANTY

If your Vintage Keeper cooling unit or cabinet fails to perform as designed within one year of the date of purchase, VINTAGE KEEPER INC. warrants that, upon your request, it will be repaired or replaced, at our option, during the one year warranty period. This warranty applies only to the first end-user purchaser of a Vintage Keeper unit that is purchased and used in the continental United States or Canada (excludes Alaska and Hawaii). It is not valid for subsequent purchasers, nor for units in use outside North America. The warranty period for your Vintage Keeper unit commences on the date you purchased it and expires one year thereafter.

PROOF OF PURCHASE

Within 10 days of purchase, complete and mail, fax or e-mail the registration sheet to VINTAGE KEEPER INC. Alternately, you may register your warranty on our Internet web site, www.vintagekeeper.com. When you make a warranty claim, you must forward a copy of your original dated bill of sale to establish your date of purchase.

IF YOU HAVE A PROBLEM WITH YOUR UNIT

Customer service and warranty problems are handled online at www.vintagekeeper.com. You will find a comprehensive well-documented and easy-to-use solution to almost any question or problem you may have. The inquiry forms are filled in on-line and connect you to our representatives who will process your requests for warranty service. This is the quickest way to solve your problems. If you do not have access to the internet you may call us from 9:00 a.m to 4:00 p.m EST, to request a WARRANTY CLAIM INFORMATION KIT. We can fax or mail it to you. You can fill in the enclosed REQUEST FOR RETURN AUTHORIZATION CODE form and return it by mail or fax. We can then promptly process your claim.

REPLACEMENT ?

At our option we may choose to offer you a replacement part or product rather than a repair. Upon your authorization to accept a replacement unit and with appropriate security (credit card authorization), we will promptly ship a replacement unit. The replacement may be a unit that has been reconditioned by VINTAGE KEEPER INC. The unit that needs service must be packed and returned to us, shipping prepaid. Upon its receipt, we will release your credit card security. Go online to the SUPPORT section on our web site at www.vintagekeeper.com to request warranty service.

REPAIR ?

If we determine that your unit needs to be repaired rather than replaced we will issue you a Return Authorization Code. Go online to the SUPPORT section of our web site at www.vintagekeeper.com to request warranty repair service. Please save the original packaging materials to facilitate shipment. Mark the Return Authorization Code clearly on the outside of the package, enclose a brief note describing the problem and send the unit, shipping prepaid, to VINTAGE KEEPER INC.

WHAT MUST YOU DO?

Your unit is designed to perform with a minimum amount of user maintenance when installed and operated precisely as directed in the manual. You are, however, responsible for the required user maintenance described in the manual, specifically, regular cleaning of the condenser coil and fans. Also, you must take steps to protect the unit from sudden power surges. As with any sensitive electronic device, your Vintage Keeper unit may be damaged by power surges or spikes, including lightning strikes, acts of god, sudden interruptions or prolonged low-voltage conditions, which are not covered by this Warranty. You must monitor your unit's performance on a daily basis. If there is an apparent problem or "Alarm" condition, you must disconnect the power supply to avoid potential damage to your wine collection. It is your responsibility to insure your wine, and to take all reasonable and necessary precautions to safeguard its condition.

WHAT THE WARRANTY DOES NOT COVER

This warranty covers only defects in materials and workmanship provided by VINTAGE KEEPER INC. and does not cover equipment damage or malfunction from misuse, abuse, accident, act of God, or any unauthorized alteration or modification. The product must have been installed and operated precisely as directed in the manual which accompanies each product. Improper return shipping, inadequate packaging or shipping damage is not covered unless the unit is packaged and shipped in accordance with Vintage Keeper replacement procedures. This product is not warranted for **COMMERCIAL USE**. Such usage will void any warranty. Third party servicing of this product during the warranty period will also void the warranty, as will any evidence of tampering or alteration to the serial number and or the original dated bill of sale.

REPLACEMENT AND REPAIR ARE YOUR ONLY REMEDIES

YOUR ONLY REMEDY UNDER THIS WARRANTY IS THE REPLACEMENT OR REPAIR OF YOUR ELIGIBLE PRODUCT AS DESCRIBED ABOVE. NEITHER THIS WARRANTY NOR ANY OTHER WARRANTY, EXPRESS OR IMPLIED, INCLUDING, BUT NOT LIMITED TO, THE IMPLIED WARRANTIES OF MERCHANTABILITY AND FITNESS FOR A PARTICULAR PURPOSE, SHALL EXTEND BEYOND THE ONE-YEAR WARRANTY PERIOD. UNDER NO CIRCUMSTANCES SHALL VINTAGE KEEPER INC. BE LIABLE FOR ANY SPECIAL INCIDENTAL, INDIRECT OR PUNITIVE DAMAGES OR FOR ANY CONSEQUENTIAL DAMAGES, INCLUDING SPOILAGE OF WINE, EVEN IF VINTAGE KEEPER INC. KNOWS OR IS INFORMED THAT SUCH DAMAGES ARE POSSIBLE. IT IS YOUR RESPONSIBILITY TO INSURE YOUR WINE, AND TAKE ALL REASONABLE, NECESSARY PRECAUTIONS TO SAFEGUARD ITS CONDITION. SOME STATES DO NOT ALLOW THE EXCLUSION OR LIMITATION OF INCIDENTAL OR CONSEQUENTIAL DAMAGES, SO THE ABOVE EXCLUSION OR LIMITATION MAY NOT APPLY TO YOU. NO RESELLER IS AUTHORIZED TO MODIFY THE TERMS OF THIS WARRANTY. ANY ADDITIONAL WARRANTY OFFERED BY A RESELLER IS THE SOLE RESPONSIBILITY OF THAT RESELLER.

SERVICE AFTER YOUR WARRANTY EXPIRES

If your unit requires service after the one-year warranty period expires, you may have it serviced locally by any qualified HVAC technician, or you may purchase a new unit at a special discount under our Extended Warranty Program. Please be ready to provide model, serial number, credit card number and a copy of your original dated bill of sale. In addition, repair service is always available direct from us at flat rates below the prevailing charges for local service. However, using our Extended Warranty Program for units under 5 years old will always be a preferable solution to returning a unit for repair. Go online at www.vintagekeeper.com to request Repair Service or see our Extended Warranty Program.



TUSCANY

110
220

Plus WINE CELLAR

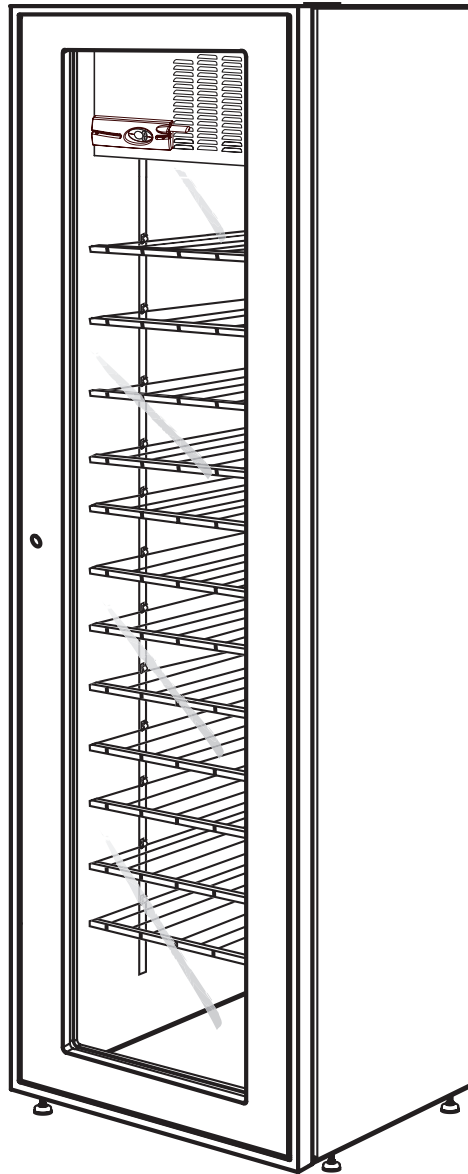

5648 McAdam Rd., Mississauga ON CAN L4Z 1T2

Phone : 905.501.8582 Fax : 905.501.0889

Toll free: 1.888.274.8813

customerservice@vintagekeeper.com

www.vintagekeeper.com