

3018CLR • 18" Clear Ice Machine • Modular 3000 Series

FEATURES & BENEFITS



STAINLESS
SOLID



INTEGRATED
SOLID

PERFORMANCE

- Daily ice production of up to 60 lbs of ice
- Up to 30 lbs in ice storage capacity
- Clear ice cube dimensions: 7/8" W x 7/8" H x 7/8" L
- Clear ice cube fullness can be adjusted
- Silent mode temporarily suspends ice making for 3 hours
- U-Select® Control with digital OLED display is ergonomically located on top of door
- Indicator alert notifies user when cleaning is needed
- Easy clean process only lasts 45 minutes

INTERIOR/EXTERIOR

- Black interior is illuminated with LED theater lighting
- Clear heavy duty ice scoop included
- Drain required
- Model can be ordered with factory installed P60 drain pump if gravity drain is not accessible
- Factory installed water and drain line simplifies installation
- Standard commercial stainless steel handle is interchangeable with professional handle accessory
- Must be ordered right-hand or left-hand hinged

INTEGRATION

- Robust, concealed and covered hinges with built-in door stop and closer
- Adjustable grille can be shifted front-to-back and up-and-down
- Grille can accept a 1/4" custom integrated toe-kick
- Integrated model requires 3/4" custom door panel (panels not supplied by U-Line)
- Four independently adjustable leveling legs; rear legs are adjustable from the front for ease of installation

MODEL DETAILS

Model	Voltage/Hz	Door Swing	Pump	Finish	Shipping Weight
U-3018CLRS-00A	115 / 60	Right-Hand Hinge	-	Stainless Solid	118 lbs
U-3018CLRS-01A	115 / 60	Left-Hand Hinge	-	Stainless Solid	118 lbs
U-3018CLRS-40A	115 / 60	Right-Hand Hinge	Pump Included	Stainless Solid	124 lbs
U-3018CLRS-41A	115 / 60	Left-Hand Hinge	Pump Included	Stainless Solid	124 lbs
U-3018CLRINT-00A	115 / 60	Right-Hand Hinge	-	Integrated Solid	110 lbs
U-3018CLRINT-01A	115 / 60	Left-Hand Hinge	-	Integrated Solid	110 lbs
U-3018CLRINT-40A	115 / 60	Right-Hand Hinge	Pump Included	Integrated Solid	116 lbs
U-3018CLRINT-41A	115 / 60	Left-Hand Hinge	Pump Included	Integrated Solid	116 lbs

ACCESSORIES

Model	Description	Finish	Shipping Weight
23074	Professional Door Handle, 1 1/4" Diameter	Stainless	2 lbs
23073	Commercial Door Handle, 7/8" Diameter	Stainless	2 lbs
U-3000FLANGE-KIT	Flange Kit, 3000 Series	Black	14 lbs
U-3000FLANGE-KIT-ICE	Flange Kit, 3000 Series, Ice*	Black	17 lbs
37050	Clear Ice Machine Cleaner (1 box of 6 packets)	na	1 lbs
P60	Drain Pump	na	7 lbs

*Ice machine must be installed on right side when installed with ice flange kit.

Modular 3000 Series • 18" Clear Ice Machine • **3018CLR**

DIMENSIONS

Dimensions shown apply to all finishes, including Integrated (INT) models with 3/4" integrated panel/frame installed.

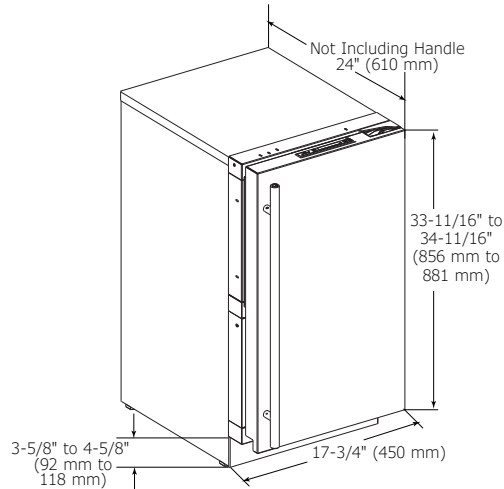

CABINET CUT-OUT

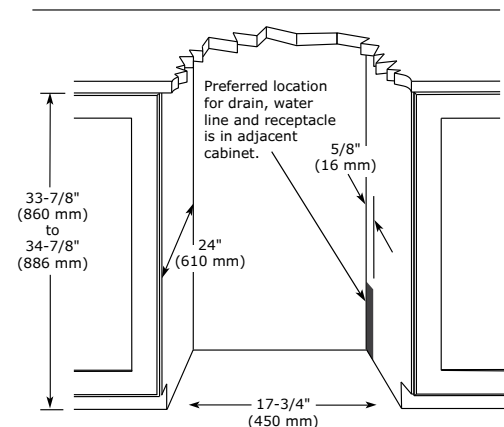

INSTALLATION NOTES

When installing adjacent to wall, ensure 2 1/2" clearance on hinged side for 90° door opening, allowing ample room for door handle.

No additional clearance around sides, top or rear of unit is needed for ventilation.

Do not obstruct front grille air flow.

SPECIFICATIONS

Model	3018CLR
Amps: Running	4
Amps: Ice Harvest	5.5
Control Type	U-Select®
Defrost Type	Automatic
Dimensions: Product Depth	24" / 610 mm
Dimensions: Product Height	33 11/16" / 856 mm
Dimensions: Product Width	17 3/4" / 450 mm
ENERGY STAR	na
Ice Production Per Day	60 lbs
Ice Storage	30 lbs
Panel Height	30" / 762 mm
Panel Thickness	3/4" / 20 mm
Panel Type	Solid Panel
Panel Width	17 1/2" / 445 mm
Product Weight: Max	114 lbs
Refrigerant Type	R134a
Sabbath (Star K Certified)	Yes

ELECTRICAL REQUIREMENTS

This unit requires a grounded a polarized 115 VAC, 60 Hz, 15 A power supply (normal household current).



Please visit u-line.com to view this model's User Guide.
All specifications are subject to change without notice.