

# Panel Ready Decorative Door Plate Installation Instructions

## Step 1

Measure the length and width of the door and decorative door plate, calculate the distance from the door to the edge of decorative door plate, and then use a ruler to draw an outline line consistent with the size of the door on the decorative plate, as indicated by the blue line in the figure.

Door Dimension:

VSK-32ADA-PRR(L): 682mm(H) x 562mm(W)

VSK-24U-PRR(L): 734mm(H) x 562mm(W)

VSBC-24L-PRR(L): 734mm(H) x 562mm(W)

VSW5134S-1PRR(L): 734mm(H) x 562mm(W)

VSW5134S-2PRR(L): 734mm(H) x 562mm(W)

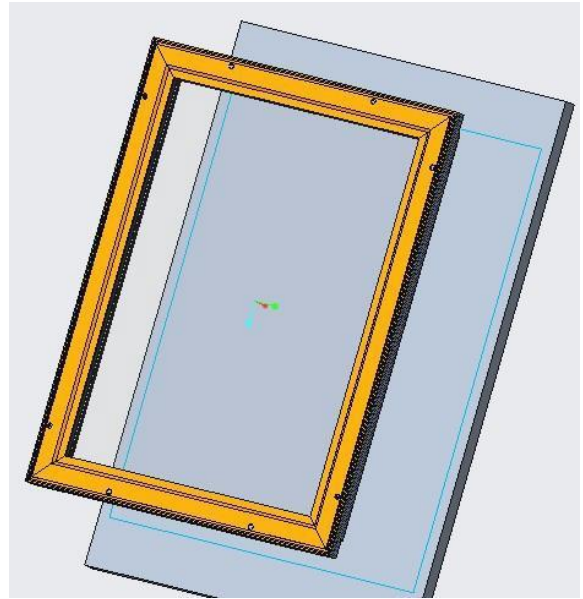

## Step 2

Align the inner wall of the decorative plate fixed block with the newly drawn outline line (Fig. 1, Fig. 2), then drill holes in the wooden board, and lock the fixed block with countersunk self-tapping 4\*13mm screws (Fig. 3, Fig. 4).

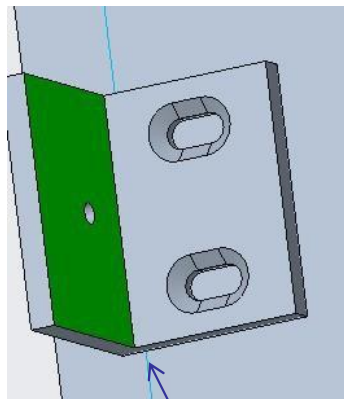

Fig. 1

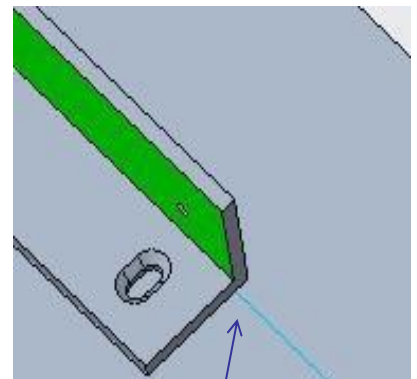

Fig. 2

The green surface aligns with the outline line you just drawn.

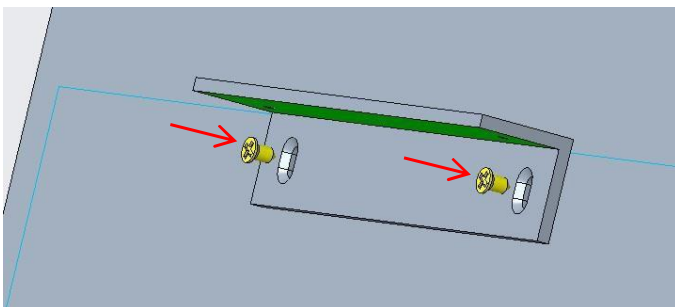

Fig. 3

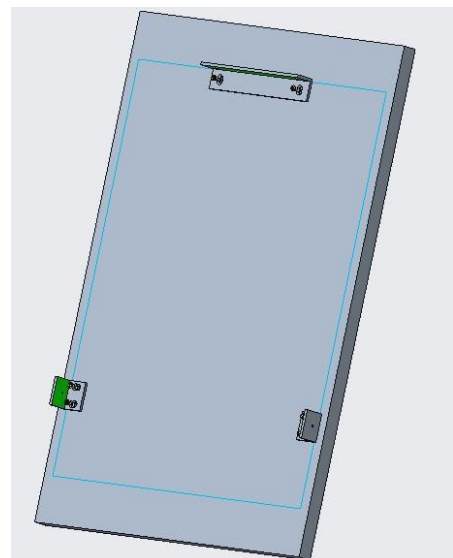
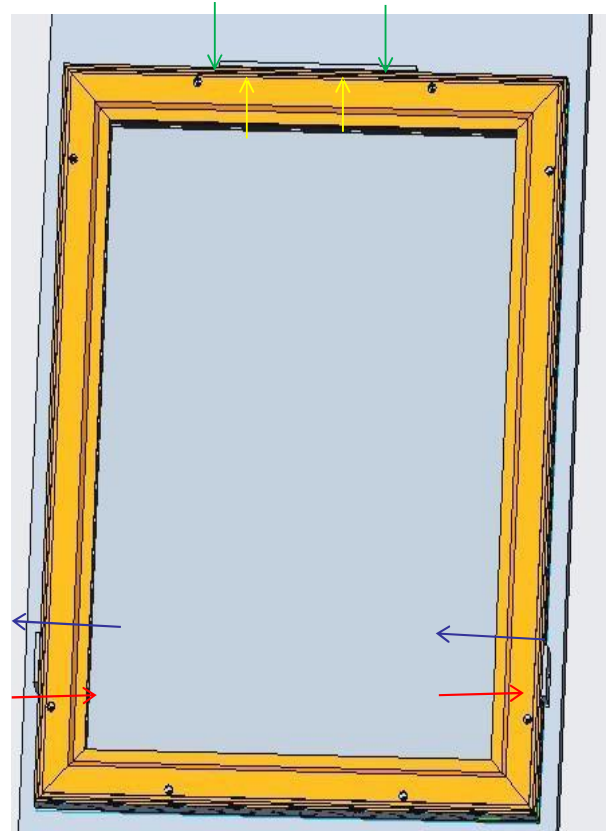
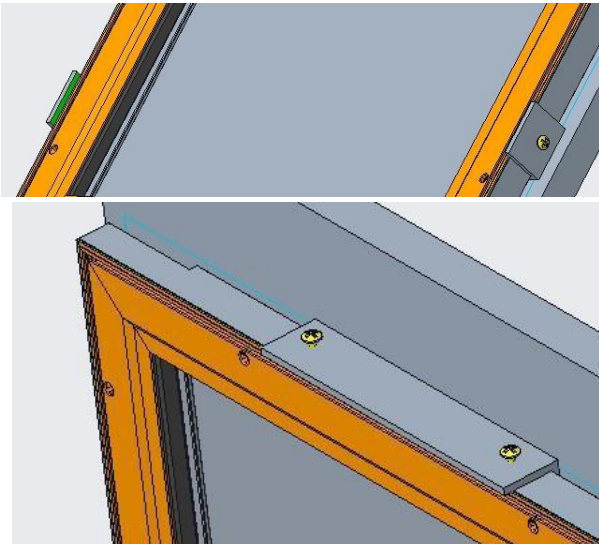

Fig. 4

# Panel Ready Decorative Door Plate Installation Instructions

## Step 3

Adjust the locking screws on the fixed block as shown in the following figure, and adjust the locking screws upwards or downwards, or leftwards or to the right, observe whether the position of the decorative plate is appropriate, adjust the position, and lock the fine-tuning screws.



## Step 4

Remove the door seal on the positions with drilled holes, and then drill a 15mm-deep hole in the decorative plate with a diameter 2mm drill bit according to the position of the hole on the back plate of the door.

Remark:

- 1) Be careful not to damage the door seal when drilling;
- 2) The depth of the drilling hole should be adjusted appropriately according to the thickness of the decorative plate to prevent the perforation or the hole from being too close to the outer surface, which may affect the appearance;
- 3) Do not remove the door seal on the 4 corners of the door (it is difficult to restore), remove it on the locations with drilled holes only.

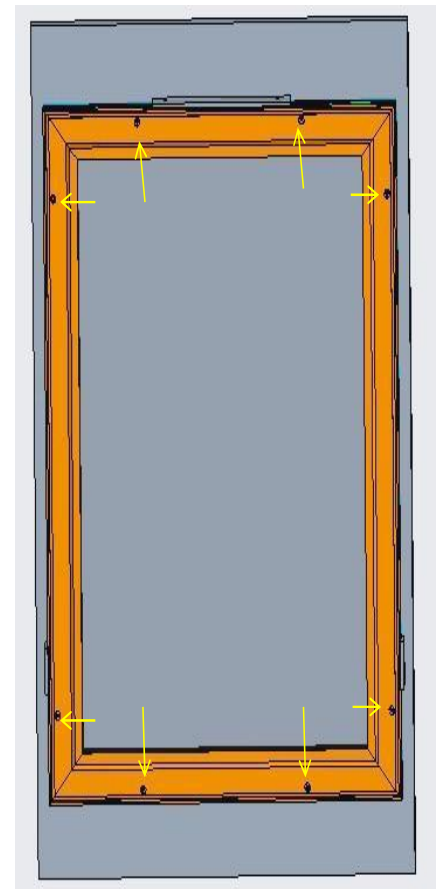

# Panel Ready Decorative Door Plate Installation Instructions

## Step 5

Remove the decorative plate from the door, unscrew the screws on the decorative plate fixed block, and remove the fixed block.

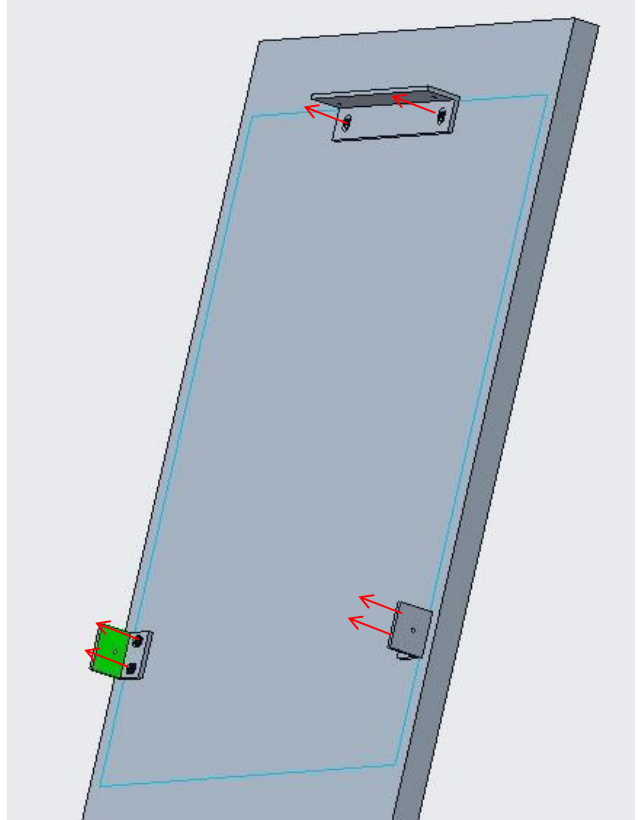
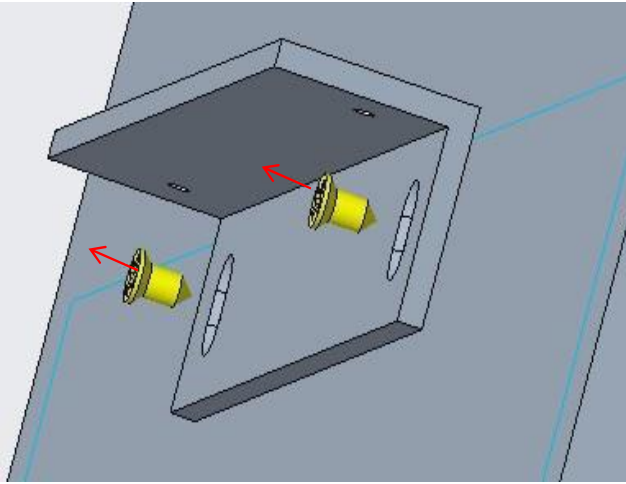

## Step 6

Lock the decorative plate to the door with screws of the right size and length, and finally restore the door seal to finish the installation.

