

Model: ICHK38SSU-L-1



## KEGCO 24" WIDE COLD BREW COFFEE SINGLE TAP OUTDOOR STAINLESS STEEL COMMERCIAL BUILT-IN LEFT HINGE KEGERATOR

### FEATURES

- SPECIALLY DESIGNED FOR DISPENSING COLD BREW COFFEE
- BUILT-IN OR FREESTANDING USE
- POWERFUL COOLING TECHNOLOGY
- DIGITAL TEMPERATURE CONTROL
- FAN FORCED COOLING PREVENTS HOT SPOTS
- LARGE STAINLESS STEEL INTERIOR
- CONVERTS TO A REFRIGERATOR

### CAPACITY OPTIONS



15.5 GAL

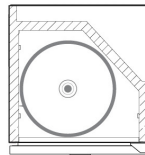

7.75 GAL

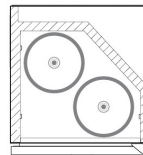

5 GAL

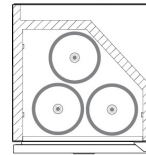

5 GAL

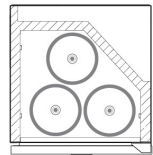

### INCLUDES DISPENSE KIT

- 15 cu. ft. Aluminum Nitrogen Tank
- Elite Series Double Gauge Nitrogen Regulator
- Set of ball lock homebrew keg couplers
- 14" Tall 3" Diameter Polished Stainless Steel Draft Tower
- Hoses and fittings



NITROGEN  
TANK



DRAFT TOWER



NITROGEN REGULATOR



BALL LOCK  
COUPLERS



 (800) 710 9939

support@beveragefactory.com  
www.beveragefactory.com

#### OUR SHOWROOM

8520 Miralani Drive  
San Diego, CA 92126

Mon-Fri, 7:00am - 4:00pm

Model: **ICHK38SSU-L-1**

## KEGCO 24" WIDE COLD BREW COFFEE SINGLE TAP OUTDOOR STAINLESS STEEL BUILT-IN LEFT HINGE KEGERATOR

### DIMENSIONS

Height	34-1/8"
Width	24"
Depth (without handle)	25"
Depth (with handle)	26.5"
Shipping Dimensions	30"x30"x43"

### WEIGHT

Unit Weight	115 lbs.
Shipping Weight	150 lbs.

### KEG STORAGE CAPACITIES

Full Size / 1/2-Barrel	Holds 1
Pony Size / 1/4-Barrel	Holds 1
1/4-Barrel Slim	Holds 2
1/6-Barrel	Holds 3
5 gal. Ball/Pin Lock Keg	Holds 3
5-Liter / Mini Keg	Holds 3

### KEY FEATURES

Built-in Capable	Yes
Keg Coupler	Yes
Security Lock	Yes
Regulator	Yes
Nitrogen Tank	Yes
Outdoor Use	Yes
Commercial Use	Yes

### ELECTRICAL

Electrical Requirements	115v/60hz
Running Amps	1.7 A

### CERTIFICATIONS

ETL Listed	Yes
ETL Sanitation Listed	Yes

### WARRANTY

Labor	1 Year
Parts	1 Year
Compressor (Parts Only)	5 Years

### EXTERIOR

Cabinet	Stainless Steel
Drip Tray	No
Guard Rail	Yes
Casters	Yes

### DOOR

Color / Material	Stainless Steel
Number of Doors	1
Door Handle	Towel/Curved
Field Reversible	No
Accepts Custom Overlay Panel	No

### DRAFT TOWER

Number of Faucets	1
Material	Stainless Steel
Height	14"
Diameter	3"

### COOLING SYSTEM

Type	Compressor
Defrost System	Manual
Front Ventilation	Yes

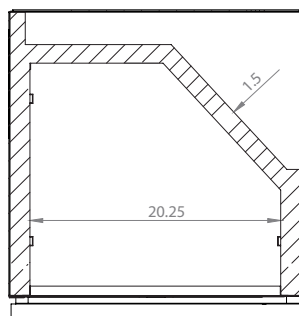
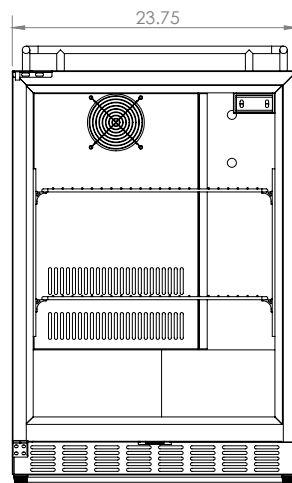
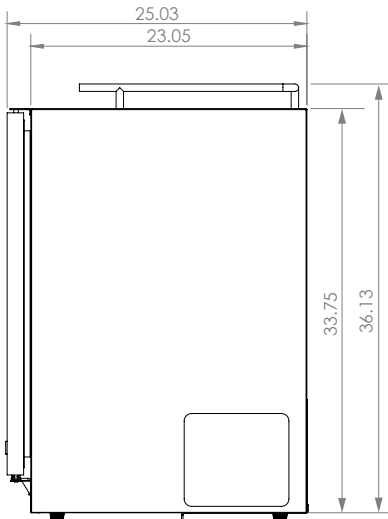

 **(800) 710 9939**

[support@beveragefactory.com](mailto:support@beveragefactory.com)  
[www.beveragefactory.com](http://www.beveragefactory.com)

### OUR SHOWROOM

8520 Miralani Drive  
San Diego, CA 92126

Mon-Fri, 7:00am - 4:00pm