

# Allavino Reserva Series 154 Bottle Dual Zone Built-in Wine Refrigerator with Stainless Steel Door - Right Hinge

## FEATURES

- STYLISH BUILT-IN WINE STORAGE
- SEAMLESS STAINLESS STEEL DOORS
- ROLLER-GLIDE SHELVES
- CUSTOMIZABLE LED LIGHTING
- 5 LEVELS OF BRIGHTNESS
- DIGITAL TEMPERATURE CONTROL
- OPEN DOOR ALARM
- INTERNAL FANS
- DUAL TEMPERATURE ZONES

## STORAGE

### BOTTLES

Holds up to 154 bottles\*

### SHELF COUNT

14 storage shelves

## TEMPERATURE

### UPPER WINE ZONE

Set Temperature 41-61°F

### LOWER WINE ZONE

Set Temperature 45-64°F

## DESCRIPTION

- Allavino Wine Refrigerator features two temperature zones to store both red and white wines at their ideal temperature
- Digital control panel allows you to precisely set the temperature in each zone independently, between 41-64 degrees Fahrenheit
- FlexCount series shelving design gives you flexible storage options for a diverse collection of up to 154 wine bottles
- Energy efficient Tru-Vino Cooling Technology delivers precise temperature control with low vibrations and ultra-quiet operation
- Designed for both built-in and freestanding use



VSW15471D-2SR



+1 888 980 4809

support@allavino.com

www.allavino.com

## OUR SHOWROOM

8510 Miralani Drive  
San Diego, CA 92126

Mon - Fri, 7:00am - 4:00pm

#### DIMENSIONS

|        |                         |
|--------|-------------------------|
| Height | 71.5"                   |
| Width  | 23.5"                   |
| Depth  | 26.75" (28.5" w/Handle) |

#### WEIGHT

|                 |            |
|-----------------|------------|
| Unit Weight     | 304.2 lbs. |
| Shipping Weight | 312 lbs.   |

#### KEY FEATURES

|                          |       |
|--------------------------|-------|
| Built-in Capable         | Yes   |
| Security Lock            | Yes   |
| Multiple / Dual Zone     | Yes   |
| Beverage Center          | No    |
| Cabinet Color / Material | Black |
| ADA Compliant            | No    |
| Commercial Use           | Yes   |
| Outdoor Use              | No    |

#### CAPACITY

|                   |                   |
|-------------------|-------------------|
| Wine Bottle Count | Up to 154 bottles |
|-------------------|-------------------|

#### CONTROLS

|                       |     |
|-----------------------|-----|
| Adjustable Thermostat | Yes |
| Digital               | Yes |

#### COOLING SYSTEM

|                   |            |
|-------------------|------------|
| Type              | Compressor |
| Defrost System    | Automatic  |
| Front Ventilation | Yes        |

#### SHELVING

|                               |                        |
|-------------------------------|------------------------|
| Type                          | Roll-Out               |
| Number of Shelves             | 14                     |
| Material                      | Metal with Wood Fronts |
| Removable                     | Yes                    |
| Adjustable                    | No                     |
| Glide-Out (Roller Assemblies) | Yes                    |
| Bottles per Shelf             | Varies                 |

#### INTERIOR

|                               |       |
|-------------------------------|-------|
| Color                         | Black |
| Compartments (Distinct Zones) | 2     |
| Lighting                      | LED   |

#### DOOR

|                        |                       |
|------------------------|-----------------------|
| Type                   | Glass                 |
| Number of Doors        | 1                     |
| Color / Material       | Stainless Steel Frame |
| Door Handle            | Towel Bar             |
| Accepts Custom Panel   | No                    |
| Tinted / UV Protective | Yes                   |
| Self-Closing           | No                    |

#### WARRANTY

|                         |         |
|-------------------------|---------|
| Labor                   | 1 Year  |
| Parts                   | 1 Year  |
| Compressor (Parts Only) | 5 Years |

## SPECIFICATION SHEET

VSW15471D-2SR

# Allavino Reserva Series 154 Bottle Dual Zone Built-in Wine Refrigerator with Stainless Steel Door - Right Hinge

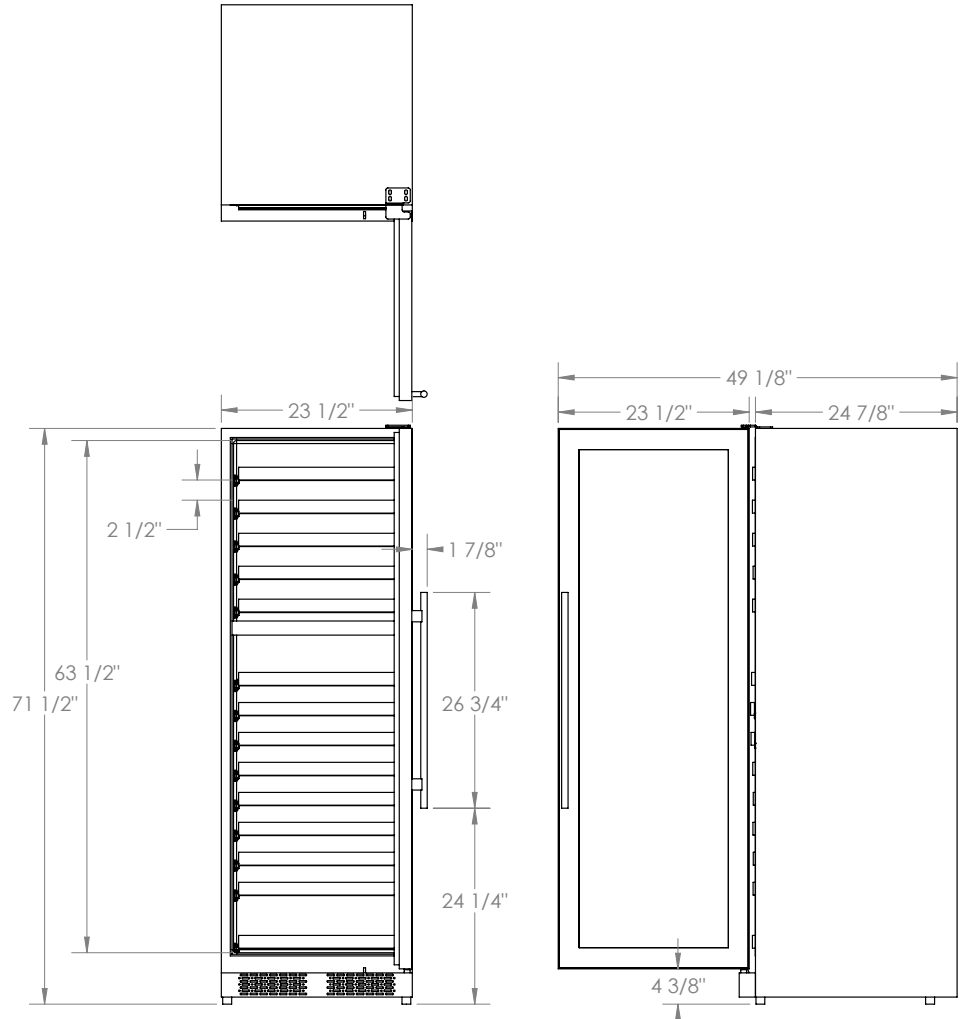

+1 888 980 4809



support@allavino.com



www.allavino.com

## OUR SHOWROOM

8510 Miralani Drive  
San Diego, CA 92126

Mon - Fri, 7:00am - 4:00pm